

PATCH CUMBERLAND POINT LLC

patch development

400 Alpha Dr
Westfield, IN 46074



9025 River Road, Suite 200 | Indianapolis, Indiana 46240
TEL 317.547.5580 | FAX 317.543.0270
www.structurepoint.com

CUMBERLAND
POINTE

NOBLESVILLE, IN

**APPROVAL PENDING
NOT FOR CONSTRUCTION**
IN SUBMITTING BIDS IN RELIANCE ON THESE PLANS THE CONTRACTOR ASSUMES ALL RISKS OF ADDITIONAL COSTS OF REVISIONS DUE TO REQUIREMENTS OF THE OWNER OR GOVERNMENTAL AUTHORITIES AND MATERIAL REVISIONS IN THE COURSE OF COMPLETING THE FINAL DESIGN.

CERTIFIED BY

ISSUANCE INDEX

DATE:	11/22/2022
PROJECT PHASE:	ISSUE FOR PERMIT

REVISION SCHEDULE

NO.	DESCRIPTION	DATE

Project Number 2022.00412

SITE PLAN

C200

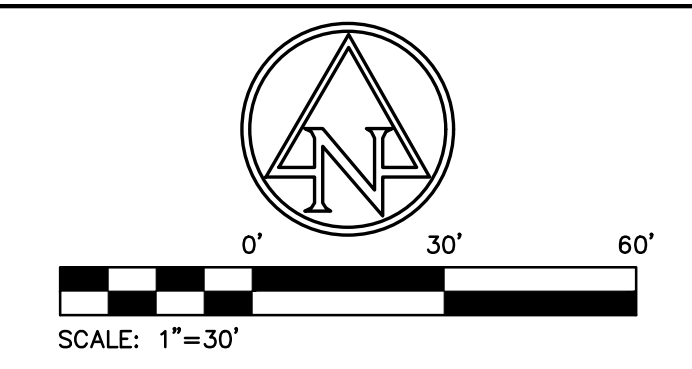

EXISTING LEGEND

- | | |
|--------------------|------------------------|
| Beehive Inlet | Telephone MH |
| Combination Pole | Telephone Pedestal |
| Curb Inlet | Transformer |
| Drainage MH | Tree |
| Fire Hydrant | TV Pedestal |
| Gas Valve | Water Valve |
| Ground Light | Buried Cable TV Line |
| Guy Wire | Buried Electric Line |
| Light Pole | Buried Gas Line |
| Pine Tree | Buried Telephone Line |
| Post | Buried Water Line |
| Sanitary MH | Overhead Electric Line |
| Sign | |
| Telephone Handhole | |
| Telephone Marker | |

SITE LEGEND

- | |
|-------------------------------|
| LIGHT DUTY ASPHALT PAVEMENT |
| HEAVY DUTY ASPHALT PAVEMENT |
| RIGHT OF WAY ASPHALT PAVEMENT |
| CONCRETE PAVEMENT |

SITE DATA TABLE

SITE ZONING:	CCPD
PROJECT AREA:	4.9± ACRES
BUILDING AREA:	56,400 SF
SITE IMPERVIOUS AREA:	1.8± ACRES
STANDARD PARKING (9'x20'):	93
ADA PARKING PROVIDED:	4
(INCLUDES 1 VAN ACCESSIBLE)	
TOTAL PROPOSED PARKING:	97

KEYNOTES

- 6" STANDARD BARRIER CONCRETE CURB
- 6" CONCRETE EXTRUDED CURB
- CONCRETE SIDEWALK
- COMBINED CONCRETE CURB & WALK
- CURB TAPER
- ADA ACCESSIBLE RAMP TYPE 'K'
- ADA PARKING SPACE (4" BLUE PAINT STRIPE)
- ADA PARKING SYMBOL
- ADA ACCESSIBLE PARKING SIGN
- PARKING SPACE (4" WHITE PAINT STRIPE)
- ADA ACCESSIBLE RAMP TYPE 'X'
- DUMPSTER PAD
- CONCRETE WHEEL STOP
- STOP SIGN
- STOP BAR, 24", WHITE, THERMOPLASTIC
- 5'x5' CONCRETE PAD
- DRIVE IN RAMP (REFER TO ARCHITECTURAL AND STRUCTURAL PLANS)
- CONCRETE ROLL CURB
- TRUNCATED DOMES
- 6'x6' CONCRETE COLLAR

- GENERAL NOTES:**
- CONTRACTOR SHALL PROTECT AND NOT DESTROY THE PROPERTY CORNER MONUMENTS DURING CONSTRUCTION.
 - CONTRACTOR TO VERIFY LOCATION, SIZE AND DEPTH OF EXISTING UTILITIES PRIOR TO COMMENCING ANY CONSTRUCTION. CONTACT ENGINEER IF VARIATION EXISTS.
 - SEE SHEET C002 GENERAL NOTES FOR MORE INFORMATION.
 - ANY CHANGES TO PLANT MATERIAL MUST BE APPROVED BY PLANNING PRIOR TO ORDERING AND/OR PLANTING.

!! CAUTION !!
THE LOCATIONS OF ALL EXISTING UNDERGROUND UTILITIES SHOWN ON THIS PLAN ARE BASED UPON ABOVE GROUND EVIDENCE (including, but not limited to, manholes, inlets, valves, and marks made upon the ground by others) AND ARE SPECULATIVE IN NATURE. THERE MAY ALSO BE OTHER EXISTING UNDERGROUND UTILITIES FOR WHICH THERE IS NO ABOVE GROUND EVIDENCE OR FOR WHICH NO ABOVE GROUND EVIDENCE WAS OBSERVED. THE EXACT LOCATIONS OF SAID EXISTING UNDERGROUND UTILITIES SHALL BE VERIFIED BY THE CONTRACTOR PRIOR TO ANY AND ALL CONSTRUCTION.
CALL TOLL FREE
811 OR 1-800-382-5544
INDIANA UNDERGROUND

DETAIL "A"
SCALE: 1" = 10'

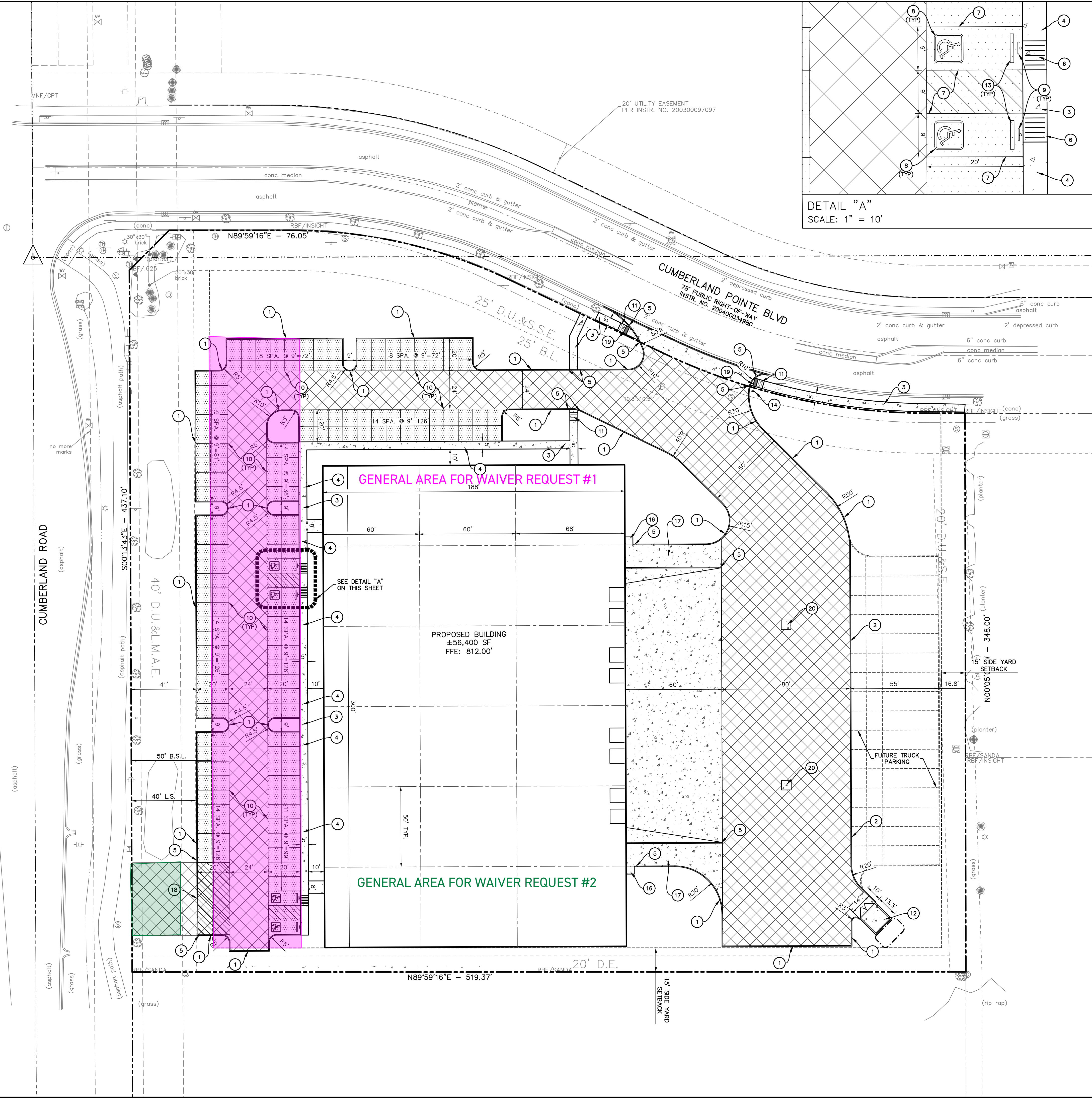
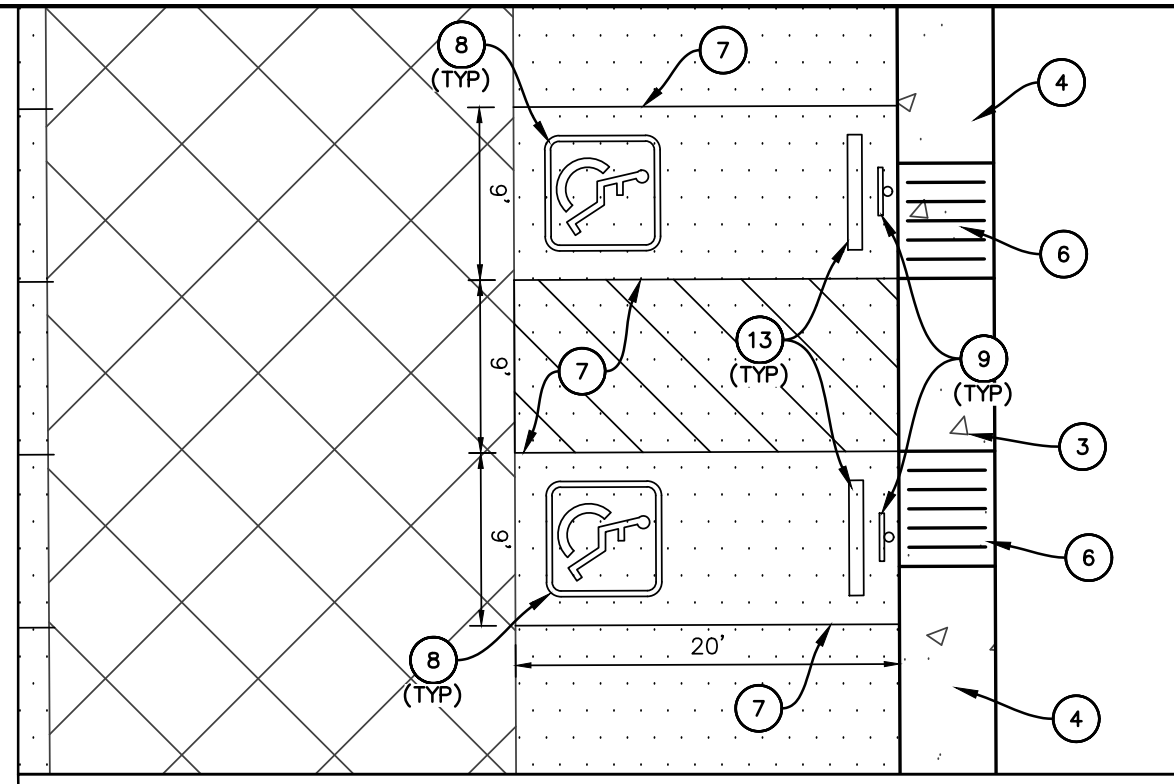

PLOT DATE: 11/22/2022 12:11 AM
 PLOT SCALE: 1:2.5849
 EDIT DATE: 11/22/2022
 EDITED BY: TSALVIA
 DRAWING FILE: P:\2022\04\20 - Drawings\Civil\Construction Documents\2022.00412.CE.C200.SP.dwg
 PROJECT: 2022.00412