



Board of Public Works and Safety

Agenda Item

Cover Sheet

MEETING DATE: June 11, 2024

- Consent Agenda Item
- New Item for Discussion
- Previously Discussed Item
- Miscellaneous

ITEM #: 15

INITIATED BY: Michael Pouch

- Information Attached
- Bring Paperwork from Previous Meeting
- Verbal
- No Paperwork at Time of Packets

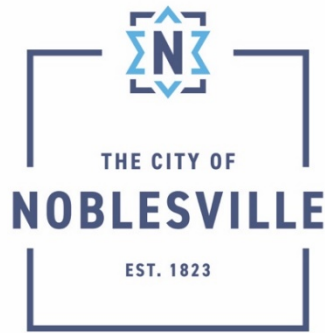

TO: BOARD OF PUBLIC WORKS AND SAFETY

FROM: MICHAEL POUCH, CONSTRUCTION MANAGER, ENGINEERING

SUBJECT: TEMPORARY CLOSURE OF E. 166th STREET FOR FINCH CREEK PLANNED DEVELOPMENT (LOCP-1692-2023)

DATE: JUNE 11, 2024

I respectfully request from the Board of Public Works and Safety permission to temporarily close a portion of East 166th Street, between Boden Road and Olio Road, for the installation of storm and sanitary sewer as proposed for the Finch Creek project. The closure is planned to begin on or after June 24, 2024, weather permitting. The road will be reopened by noon Thursday June 27th.

- Detour route will be posted in advance of the closure.
- Advance notice signs stating "Road Closure On/Or After xx/xx/2024" will be placed a minimum of one week in advance of the closure.
- Notice will be sent to public agencies informing them of the actual start of the closure.

A representative of the developer, Pulte Homes, is available to answer questions.

I recommend the Board of Public Works and Safety permit the temporary closure of E. 166th Street for storm and sanitary sewer installation for Finch Creek.

Your consideration in this matter is appreciated.

Attachments:

1. Road Closure Map

GRAPHIC SCALE
 500' 1000' 1500'
 SCALE: 1" = 500'

- GENERAL NOTES**
- CONTRACTOR SHALL ERECT AND MAINTAIN ALL NECESSARY SIGNS, DRUMS, DETOUR SIGNS AND WARNING DEVICES REQUIRED TO SAFELY DIRECT TRAFFIC OVER OR AROUND THE PART OF THE ROADWAY WHERE PERMITTED OPERATIONS ARE TO BE DONE SO LONG AS THE WORK DOES NOT INTERFERE WITH TRAFFIC, IN ACCORDANCE WITH SECTION "VI" OF THE INDIANA MANUAL OF UNIFORM TRAFFIC CONTROL DEVICES.
 - ROUTINE INSPECTIONS OF THE TRAFFIC CONTROL ZONE AND TRAFFIC CONTROL DEVICES SHALL BE PERFORMED ON A REGULAR BASIS. TRAFFIC CONTROL DEVICES REQUIRING REPAIR OR MAINTENANCE SHALL BE REPAIRED OR REPLACED IMMEDIATELY. INSPECTIONS SHALL BE SCHEDULED DURING DAYLIGHT HOURS AS WELL AS DAYLIGHT HOURS.
 - ALL EXISTING ROADS MUST BE BROUGHT BACK TO ORIGINAL OR BETTER CONDITION.
 - ALL EXISTING PAVEMENT MARKINGS WITHIN THE LIMITS OF ROAD IMPROVEMENTS WILL NEED TO BE REPLACED WITH THERMOPLASTIC MARKINGS.

LEGEND:

| | | | | | | | |
|---------------------------------|----------------------------|--|--------------------------|--|--------------------------------|----------------|----------------|
| (A) ROAD CLOSED AHEAD XW20-3 | (B) DETOUR AHEAD XW20-2 | (C) ROAD CLOSED TO THRU TRAFFIC R11-4 DETOUR XM4-10 (R) | (D) ROAD CLOSED R11-2 | (E) ROAD CLOSED TO THRU TRAFFIC R11-4 DETOUR XM4-10 (L) | (F) END CONSTRUCTION XG20-2 | (G) R3-2-A (R) | (H) R3-2-A (L) |
| (I) DETOUR | (J) DETOUR | (K) DETOUR | (L) DETOUR | (M) DETOUR | (N) DETOUR | (O) DETOUR | (P) DETOUR |

Construction Area (hatched box)

Typical Sign Standard (Detour Route Marker Assembly)

Typical Sign Standard (Road Closure Assembly)

Standard Type III-A Barricade as Required

Standard Type III-B Barricade as Required

** DISTANCES BETWEEN SIGNS
 URBAN - 100 FT
 RURAL - 500 FT (REDUCE TO 350 FT IF LIMITED ROOM)

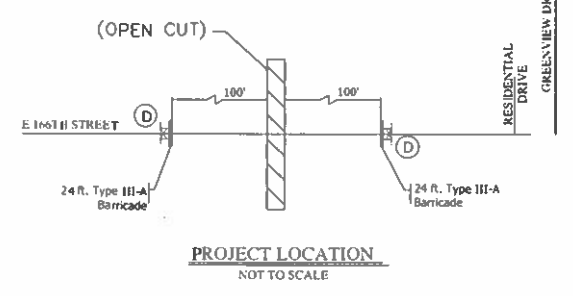
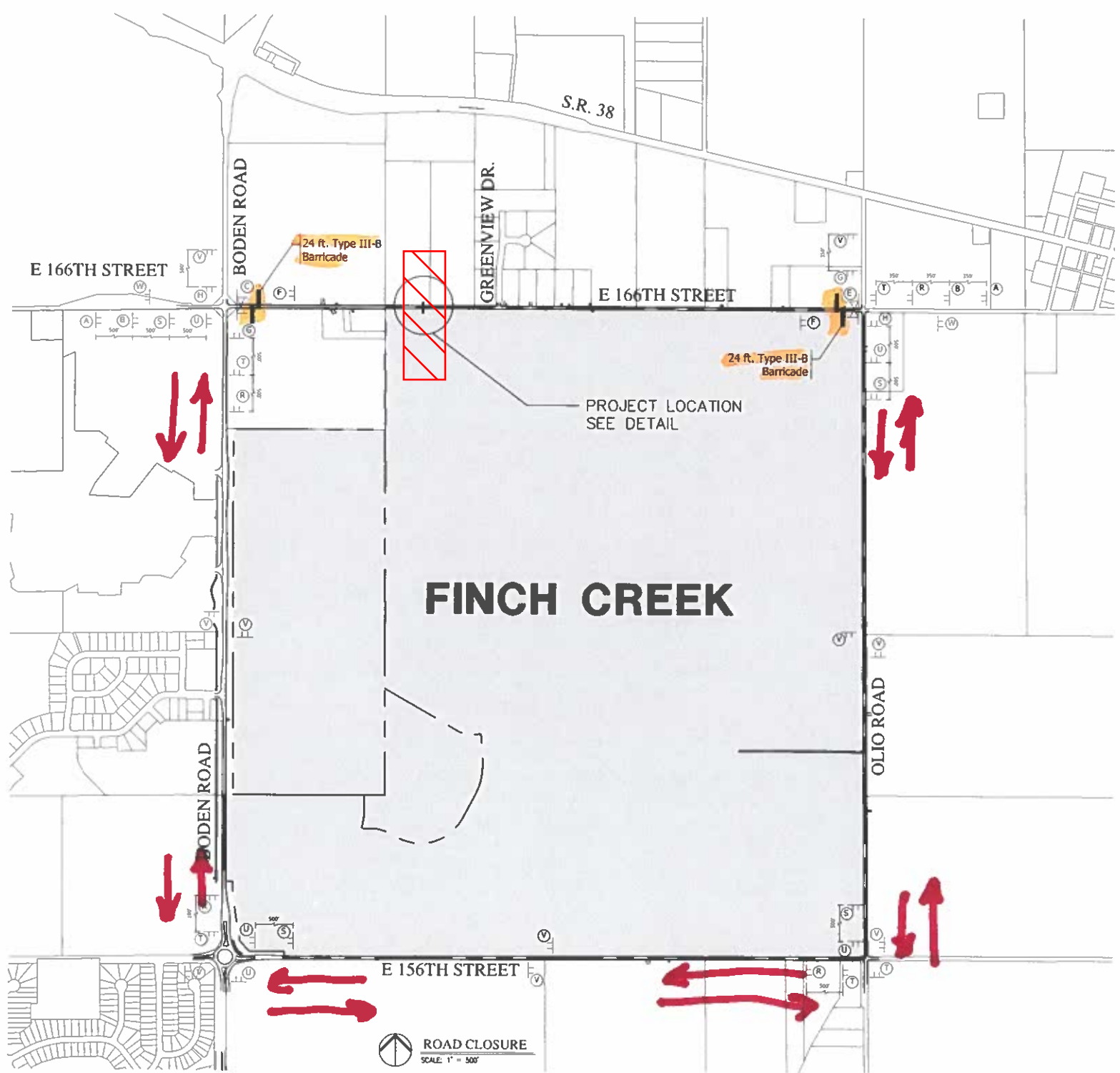

166th STREET CLOSURES / LANE RESTRICTION

ALL LANE RESTRICTIONS FOR CONSTRUCTION ON 166th STREET WILL REQUIRE NOBLESVILLE BOARD OF PUBLIC WORKS AND SAFETY APPROVAL. CONTRACTOR TO SUBMIT ANTICIPATED CLOSURE DATE AND DURATION FOR APPROVAL IN ADVANCE OF ANY CLOSURE.

ROAD CLOSURE(S) TIME FRAMES CANNOT OVERLAP ANY OTHER FINCH CREEK ROAD CLOSURE ON ALONG THE DETOUR ROUTE.

MAXIMUM TIMEFRAME: ANY CLOSURE/RESTRICTION SHALL BE LIMITED TO A MAXIMUM TIME PERIOD OF TWO (2) WEEKS

| DATE | DESCRIPTION | BY |
|----------|--------------------------|-------|
| 02/01/23 | REVISED PER TAC COMMENTS | DC/KS |
| 03/20/23 | REVISED PER TAC COMMENTS | DC/KS |
| 03/20/23 | REVISED PER HW COMMENTS | DC/KS |
| 04/21/23 | REVISED PER HSE COMMENTS | DC/KS |
| 05/15/23 | REVISED PER HSE COMMENTS | DC/KS |



**PARKSIDE AT FINCH CREEK SECTION 1
 NOBLESVILLE, INDIANA
 MAINTENANCE OF TRAFFIC PLAN -
 166TH STREET, ROAD CLOSURE**



DRAWN BY: DC
 CHECKED BY: BB
 DATE: NOVEMBER 20, 2023
 SCALE: AS SHOWN
 SHEET: C3.3
 MAINTENANCE OF TRAFFIC PLAN - 166TH STREET, ROAD CLOSURE

Plot Date: May 15, 2024 Plot Time: 10:58am File Name: W:\Pulte Homes\2017-266-F Pulte- Parkside Sec 1\Design\DD\17266-F.M01 166th Road Closure Plan.dwg, Layout: C3.3 By: dchastler/ld