

03nl-15-1732

APPROVED 10-20-03

PLAN COMMISSION

# PRAIRIE LAKES

S I G N P A C K A G E



N O B L E S V I L L E , I N

**REVISED**



# **SIGN PROGRAM**

## **For Prairie Lakes**

### **Contents**

- **Site Development Plan**
- **Retail Tenant Signage**
- **Primary Anchor Tenant (Marsh)**
- **Out Lot Signage**
- **Designation Signs**
- **Directional Signs**

## **RETAIL TENANT SIGNS**

1. All tenant signs will be individual, internally illuminated letters with aluminum channels fabricated 5" deep and will have translucent faces attached to the channels with 1" trim cap. Illumination will be from an internal light source installed within the letter channels. The light source may be either LED's or neon tubing. Energy efficient lighting is encouraged. The color and style of the letters will be subject to the Developer's approval. Each tenant's customary signature, logo, hallmark, insignia, or other trade identification will be respected.
2. Tenant signs will be centered within the limits of the demised unit. Signs mounted on brick will require fabricated aluminum raceways behind the copy. The raceways will be finished to blend with the wall background. All other tenant signs will be flush mounted to the wall surface. Sign layouts and sizes must conform to the Sign Ordinance for The City of Noblesville.
3. The electrical sign wiring must be installed in accordance with Underwriter's Laboratories Rules and Regulations. All primary and secondary wiring installed through the façade must be encased in flexible metal conduit or electrical metallic tubing with proper fasteners. All transformers must be enclosed and are to be mechanically grounded.
4. Box type signs, banners, streamers and external paper posters are prohibited.

PRODUCTION NO: \_\_\_\_\_  
\_\_\_\_\_

# RETAIL TENANT SIGNS

Size of tenant's sign  
subject to ordinance

## Retail Tenant Signs

- All tenant signs will be illuminated channel letters. Aluminum construction made of .063 (thickness) 5" deep returns painted to match customers specifications. Gloss finish on all letters. Letter faces to be 1/8" acrylic with 1" trimcap. Internally Illuminated with either neon tubing or LED's. Energy efficient illumination is encouraged. Each tenant's customary logo or "identity" will be respected.
  - All Signage must be in accordance with U.L. rules and regulations  
This includes all wiring and components of electrical including flexible metal conduit used to pass through the facade. All transformers must be enclosed and grounded properly.
- Box type signs, banners, streamers and external paper posters are prohibited.

**FLUSH MOUNTED**  
INTERNALLY ILLUMINATED

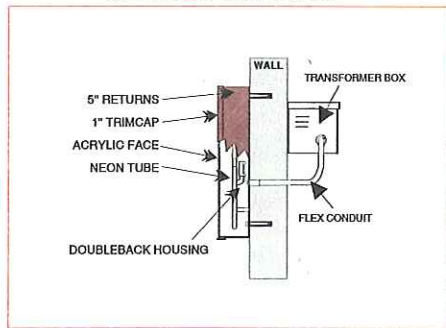

**RACEWAY MOUNTED**  
INTERNALLY ILLUMINATED

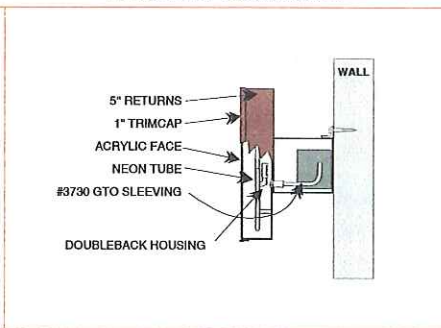

8920 CORPORATION DR. OFFICE 317.842.8664  
INDIANAPOLIS, IN 46256 FAX 317.842.3015



PREPARED FOR:  
MARSH  
NOBLESVILLE MARSH CENTER

SKETCH NAME  
MARSH PRAIRIE LAKES RETAIL TENANT SIGNS 1  
DATE:  
SEPTEMBER 8, 2003

APPROVAL DATE: \_\_\_\_\_  
SCALE:  
1/4" = 1' 0"  
S.C. REP  
STEVE McVICKER  
Smcvicker@buysigncraft.com

CUSTOMER APPROVAL: \_\_\_\_\_

NOTE: THIS DRAWING WAS CREATED BY SIGN CRAFT INC. FOR YOUR APPROVAL  
IT IS NOT TO BE REPRODUCED, COPIED, OR EXHIBITED IN ANY FASHION

## PRIMARY ANCHOR TENANT (MARSH)

1. Two (2) building signs will be allowed. Both signs are to be installed on the front elevation of the building.
2. One (1) sign will be a primary identification sign. The sign will consist of individual, internally illuminated letters with aluminum channels fabricated 5" deep of aluminum and will have translucent faces. The illumination is to be by internal LED's mounted within the letter channels. The color of the letters will be red and white with black and gold highlights on the white letters. The logo will be green with black and white detail. The letters will be mounted on fabricated aluminum raceway segments finished to blend with the building. The red copy will mount on an aluminum panel finished black. The overall size of the sign is limited to 12'-0" in height and 22'-0" in length. The placement of the sign is to be on the front elevation of the building within the glass portion of the storefront. The items of information contained on this sign will not exceed ten (10).
3. One (1) sign will be a variable message sign. The sign will consist of exposed red LED's mounted within a fabricated aluminum frame that will be finished black. The sign will measure 1'-1" in height and 57'-3" in length. The sign will be flush mounted over the entry of the building. ~~The copy on the sign will not be displayed less than sixty seconds.~~ The copy will turn off and turn back on displaying different information. The message board will not exceed ten (10) items of information at any given time. Copy can be changed once every 24 hours (not less)
4. The developer may choose to establish additional anchor tenants within the retail section of the development. These anchor tenants will be restricted to the sign criteria established for retail tenants with the exception of size limitations. The size of future anchor tenant signs will be limited only by the sign ordinance for Noblesville. The placement of anchor tenant signs will be subject to the Developer's approval.

## OUT LOT SIGNS

1. Out lot building occupants will be entitled to individual wall signs.
2. Wall signs are to be individual, internally illuminated letters fabricated with 5" deep aluminum channels. The faces of the letters may be either aluminum or translucent material. Illumination is to be provided by an internal light source and may be either LED's or neon tubing. Energy efficient lighting is encouraged. Signs utilizing the occupant's customary signature, logo, hallmark, insignia, or other trade identification will be respected.
3. Wall signs are to be placed on the building in a tasteful manner. Signs will be located below the roofline of the elevation on which the sign is located. Out lot building occupants with two street frontages will be entitled to an additional sign per frontage.
4. Letters may be flush mounted, raceway mounted or projected off the wall surface for a backlit effect.
5. The electrical sign wiring must be installed in accordance with Underwriters Laboratories Rules and Regulations.
6. The size of signs will be subject to the allowance provided by the current sign ordinance.
7. Box type building signs are prohibited.
8. Each out lot will be entitled one (1) directional sign per street frontage. The signs are to be installed on the Mundy Drive frontage and are to have a minimum setback of 5' from the right of way.
9. Out lot buildings with drive thru services will be allowed menu boards and other customary directional signs as defined in the sign ordinance for Noblesville.
10. During the construction phase of an out lot building, a construction sign may be installed in accordance with the size and placement of the sign ordinance for Noblesville.



PRODUCTION NO: \_\_\_\_\_

# OUT LOT SIGNS

Size of tenant's sign subject to ordinance

## OUT LOT SIGNS

1. Tenant signs are to be individual, internally illuminated channel letters fabricated with 5" deep aluminum returns. The faces of the letters may be either aluminum or translucent acrylic. Illumination is to be provided by an internal light source and may be either LED's or neon tubing. Energy efficient lighting is encouraged. All tenant's corporate signature, logo, hallmark, insignia, or other trade identification will be respected.
2. Channel Letters may be flush mounted, raceway mounted or projected off the wall surface for a backlit-halo effect.
3. Individual channel letters wiring must be installed in accordance with Underwriters Laboratories Rules and Regulations.

A temporary site sign may be used during the construction phase of an outlot building. If within the size and placement requirements for Noblesville.

**FLUSH MOUNTED**  
INTERNALLY ILLUMINATED

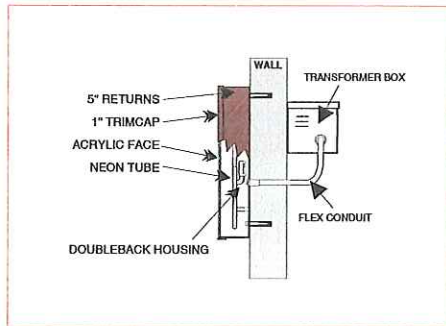

**RACEWAY MOUNTED**  
INTERNALLY ILLUMINATED

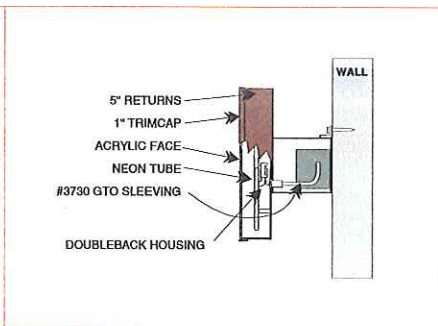

**STUD MOUNTED**  
INTERNALLY HALO-ILLUMINATED

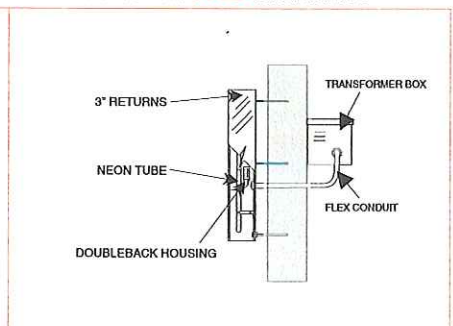

8920 CORPORATION DR. OFFICE 317.842.8664  
INDIANAPOLIS, IN 46256 FAX 317.842.3015



CUSTOMER APPROVAL:

APPROVAL DATE: \_\_\_\_\_

PREPARED FOR:  
MARSH  
NOBLESVILLE MARSH CENTER

SKETCH NAME  
MARSH PRAIRIE LAKES OUT LOT SIGNS I  
DATE:  
SEPTEMBER 8, 2003

SCALE:  
1/4" = 1' 0"  
S.C. REP.  
STEVE McVICKER  
Smcvicker@buysigncraft.com

NOTE: THIS DRAWING WAS CREATED BY SIGN CRAFT INC. FOR YOUR APPROVAL IT IS NOT TO BE REPRODUCED, COPIED, OR EXHIBITED IN ANY FASHION

## DESIGNATION SIGNS

1. The development will be allowed two (2) designation type signs. The signs will be internally illuminated and fabricated with aluminum framing and divided into tenant sections. The primary tenant section will have flexible vinyl substrate face panels with smooth copy graphics. The other tenant faces will be flat polycarbonate face panels with smooth vinyl copy. The top of the each designation sign will have a name panel for the development routed out of the aluminum face panel and backed up with translucent acrylic. The name of the development will not be counted against the items of information allowed. Each sign structure will be a light taupe and the background of the tenant panels will be white. No restriction will be placed on the style or color of tenant copy. The illumination of the sign is to be by high output fluorescent lamps mounted within the sign frames. The signs will incorporate a single band exposed neon tubing set within a reveal under the top section of the sign. Each sign will be supported by two (2) steel poles and concealed within the framework of the sign. The base supports of each sign will include decorative masonry. The overall height of each sign will be 25' and the overall width of the signs will be 14'-0". The overall width of the supporting structure will be 19'-0".
2. The placement of the designation signs will be on the north and south ends of the development. The north sign will be oriented toward the intersection of 146<sup>th</sup> Street and State Road 37. The south sign will be oriented toward the intersection of 141<sup>st</sup> Street and State Road 37.



PRODUCTION NO: \_\_\_\_\_

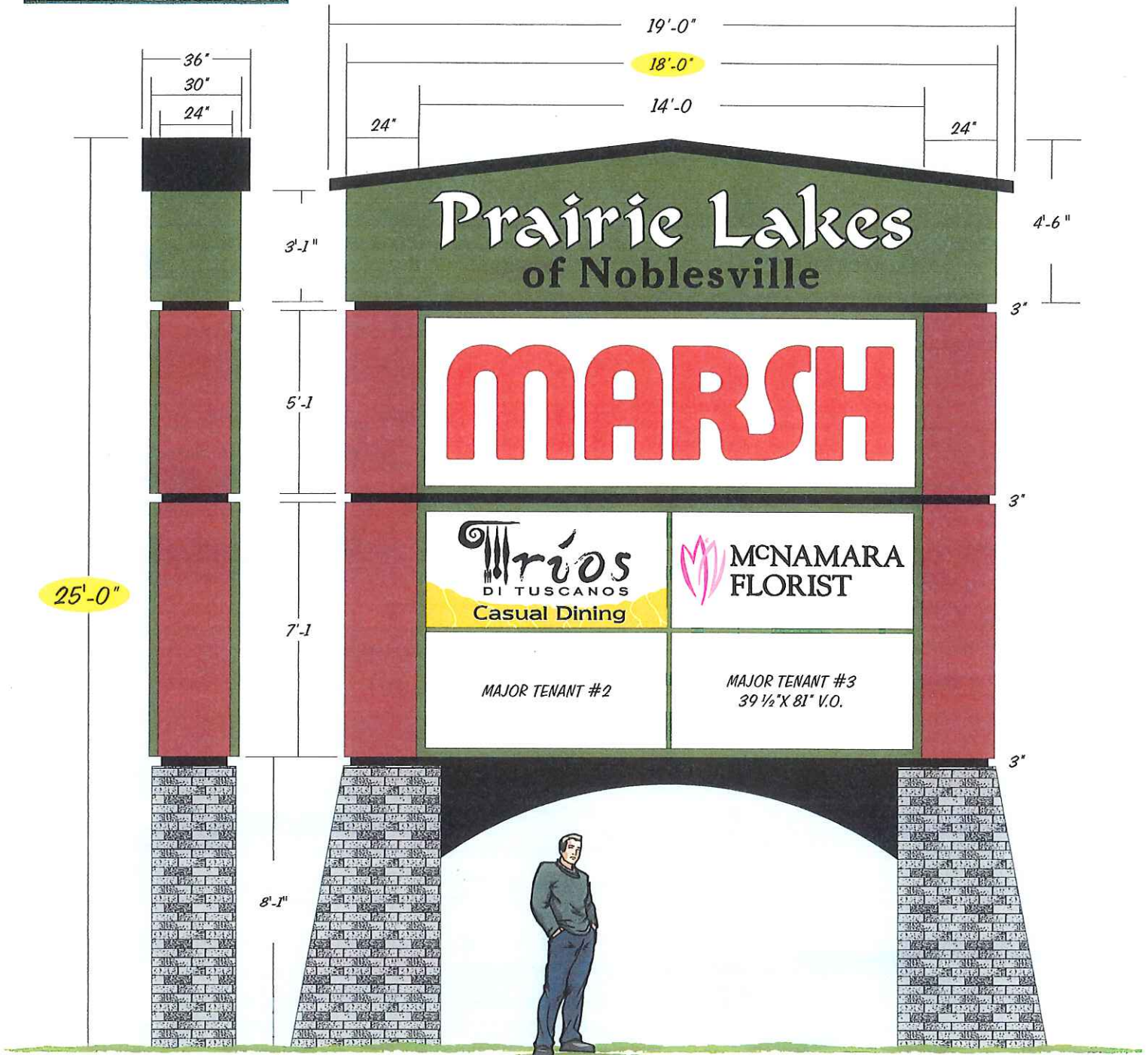

8920 CORPORATION DR. OFFICE 317.842.8664  
 INDIANAPOLIS, IN 46256 FAX 317.842.3015



PREPARED FOR:  
 MARSH  
 NOBLESVILLE MARSH CENTER

SKETCH NAME  
 MARSH PRAIRIE LAKES PYLON 2R  
 DATE:  
 OCTOBER 8, 2003

CUSTOMER APPROVAL:

APPROVAL DATE: \_\_\_\_\_

SCALE:  
 1/4" = 1' 0"

S.C. REP.  
 STEVE McVICKER  
 Smcvicker@buysigncraft.com

SALES REPRESENTATIVE: \_\_\_\_\_ DATE: \_\_\_\_\_

NOTE: THIS DRAWING WAS CREATED BY SIGN CRAFT INC. FOR YOUR APPROVAL IT IS NOT TO BE REPRODUCED, COPIED, OR EXHIBITED IN ANY FASHION



PRODUCTION NO: \_\_\_\_\_

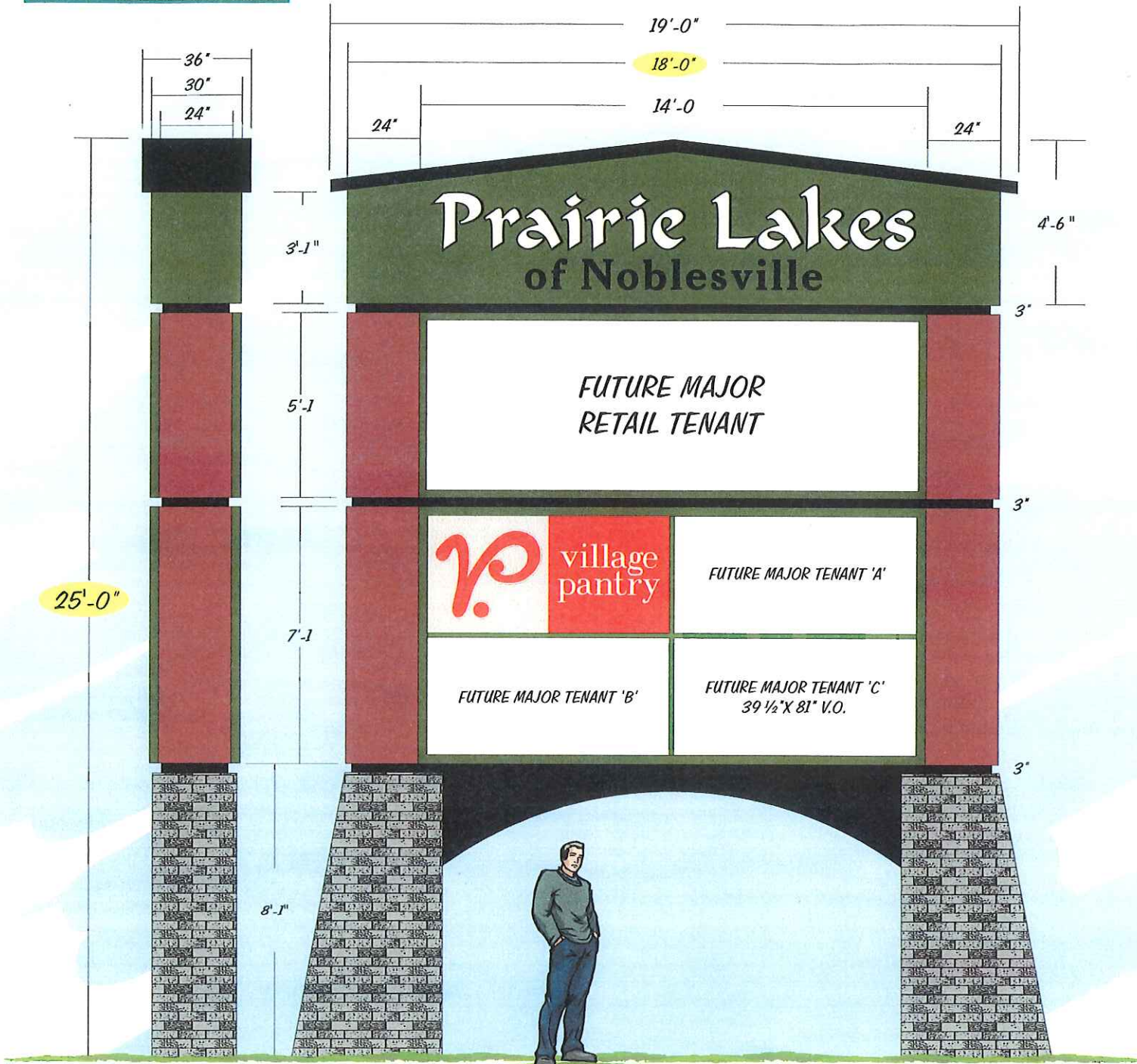

8920 CORPORATION DR. OFFICE 317.842.8664  
 INDIANAPOLIS, IN 46256 FAX 317.842.3015



PREPARED FOR:			SKETCH NAME			SCALE:		
MARSH NOBLESVILLE MARSH CENTER			MARSH PRAIRIE LAKES PYLON 3R			1/4" = 1' 0"		
DATE:			S.C. REP.			APPROVAL DATE:		
OCTOBER 8, 2003			STEVE McVICKER			_____		
SCALE: 1/4" = 1' 0"			DATE:			_____		
_____			_____			_____		

NOTE: THIS DRAWING WAS CREATED BY SIGN CRAFT INC. FOR YOUR APPROVAL  
 IT IS NOT TO BE REPRODUCED, COPIED, OR EXHIBITED IN ANY FASHION

## **DIRECTIONAL SIGNS**

1. Directional signs are to be double sided and internally illuminated. The signs and support bases are to be of consistent design and construction.
2. The design, copy, size and placement of the signs are to meet the Noblesville standards for directional signs.

PRODUCTION NO: \_\_\_\_\_

# DIRECTIONAL SIGNS

4sq FT

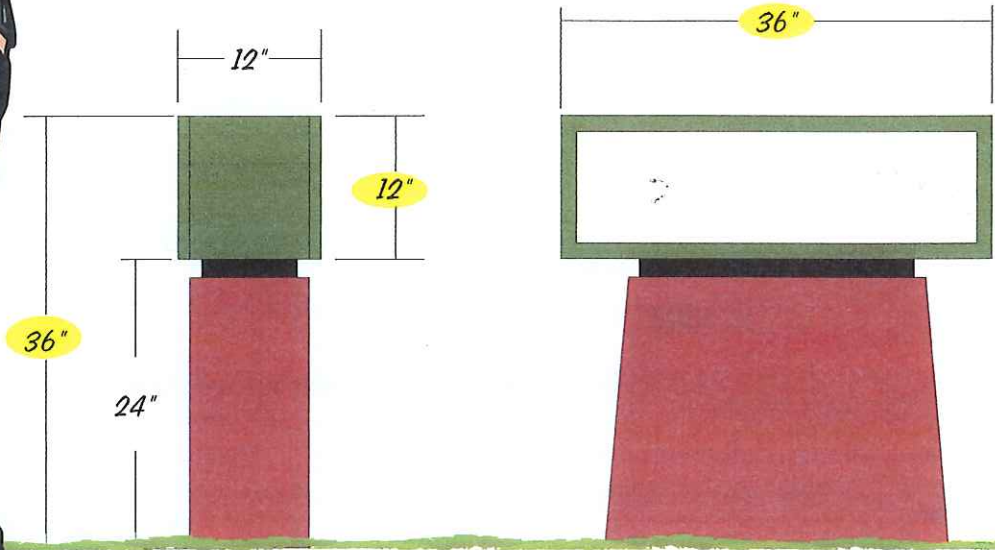

## Directional Signs

### I. Sign Cabinet

Aluminum construction internally illuminated double faced tenant panels  
3/16" white polycarbonate faces with translucent vinyl applied to 1st surface  
Sign cabinet will be painted to match building colors. ~~Copy layouts with customary signatures, logos, ballmarks, initials, or other trade identification will be respected.~~

### Sign base & reveal

Aluminum frame construction with aluminum skin painted gray to simulate the color of the stone used on the designation signs.



8920 CORPORATION DR. OFFICE 317.842.8664  
INDIANAPOLIS, IN 46256 FAX 317.842.3015



PREPARED FOR:

MARSH  
NOBLESVILLE MARSH CENTER

SKETCH NAME

MARSH PRAIRIE LAKES DIRECTIONAL 2C

DATE:

OCTOBER 8, 2003

APPROVAL DATE: \_\_\_\_\_

CUSTOMER APPROVAL:

SCALE:  
3/4" = 1' 0"

S.C. REP.

STEVE McVICKER  
Smcvicker@buysigncraft.com

SALES REPRESENTATIVE

DATE

NOTE: THIS DRAWING WAS CREATED BY SIGN CRAFT INC. FOR YOUR APPROVAL IT IS NOT TO BE REPRODUCED, COPIED, OR EXHIBITED IN ANY FASHION



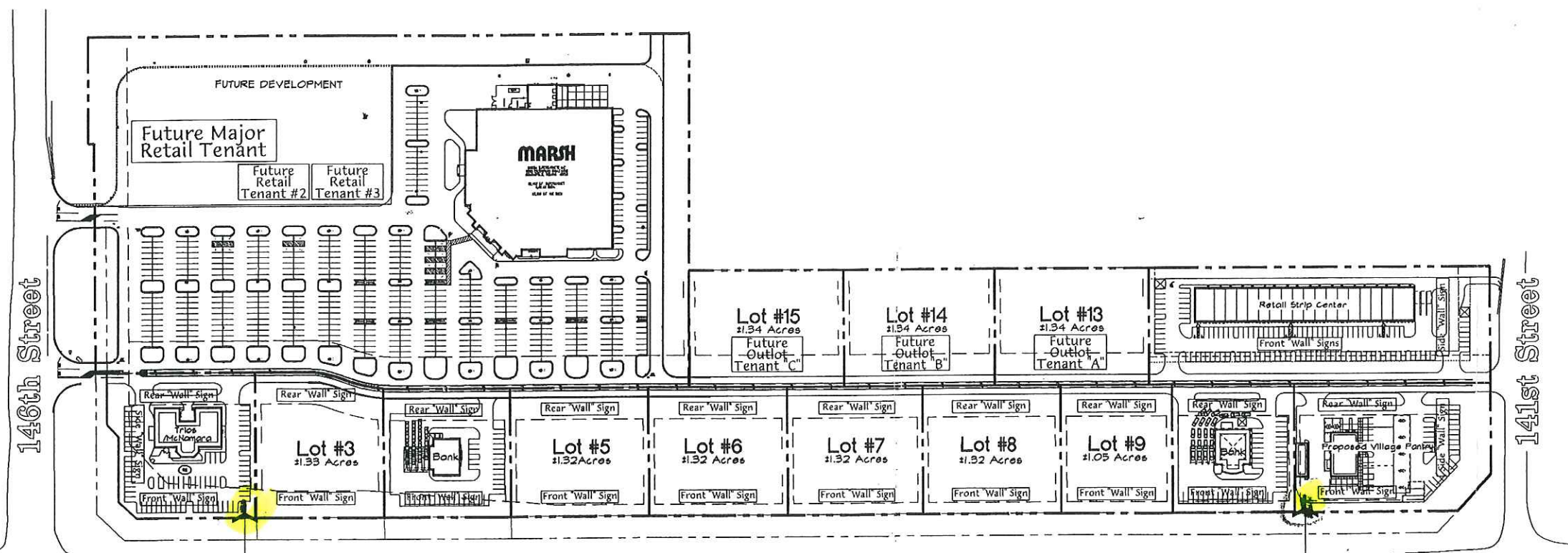

Traffic Signal

Pylon Sign #1  
SCALE: 3/16" = 1'-0"

State Road 37

Pylon Sign #2  
SCALE: 3/16" = 1'-0"

Traffic Signal



Proposed Pylon Signage Site Plan  
SCALE: 1" = 100'-0"

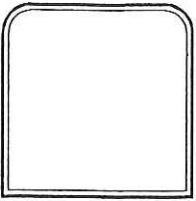
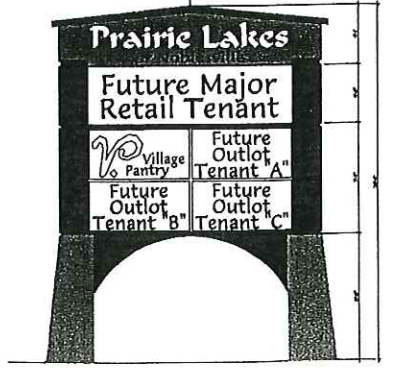

**LEECH-HENSLEY ARCHITECTS<sup>PC</sup>**  
 7785 East 126th St, Fishers, IN 46038  
 IN 317.842.1831 Fax 317.842.7994

DRAWING REVIEW ISSUE	
September 30, 2009	
BUILDING AGENCY SUBMITTAL	
CONSTRUCTION BID/ISSUE	
REVISIONS	
PRELIMINARY	
FILE - SHX - THE	
1 DRAWING SHEET	
PLOT SCALE	DRAWN BY:
1/4" = 1'-0"	

**146th & SR 37**

**MARSH**  
 2000 INDUSTRIAL BLVD  
 FISHERS, IN 46038

NOBLESVILLE, INDIANA  
 development proposed by  
 Marsh Supermarkets, LLC

Prelim. Site Plan  
 Scheme #

**9Sgn**

PROJECT NO.  
 0100bp



ILLUMINATED CHANNEL LETTERS

PRODUCTION NO: \_\_\_\_\_ "Fresh Marsh" #37  
Noblesville

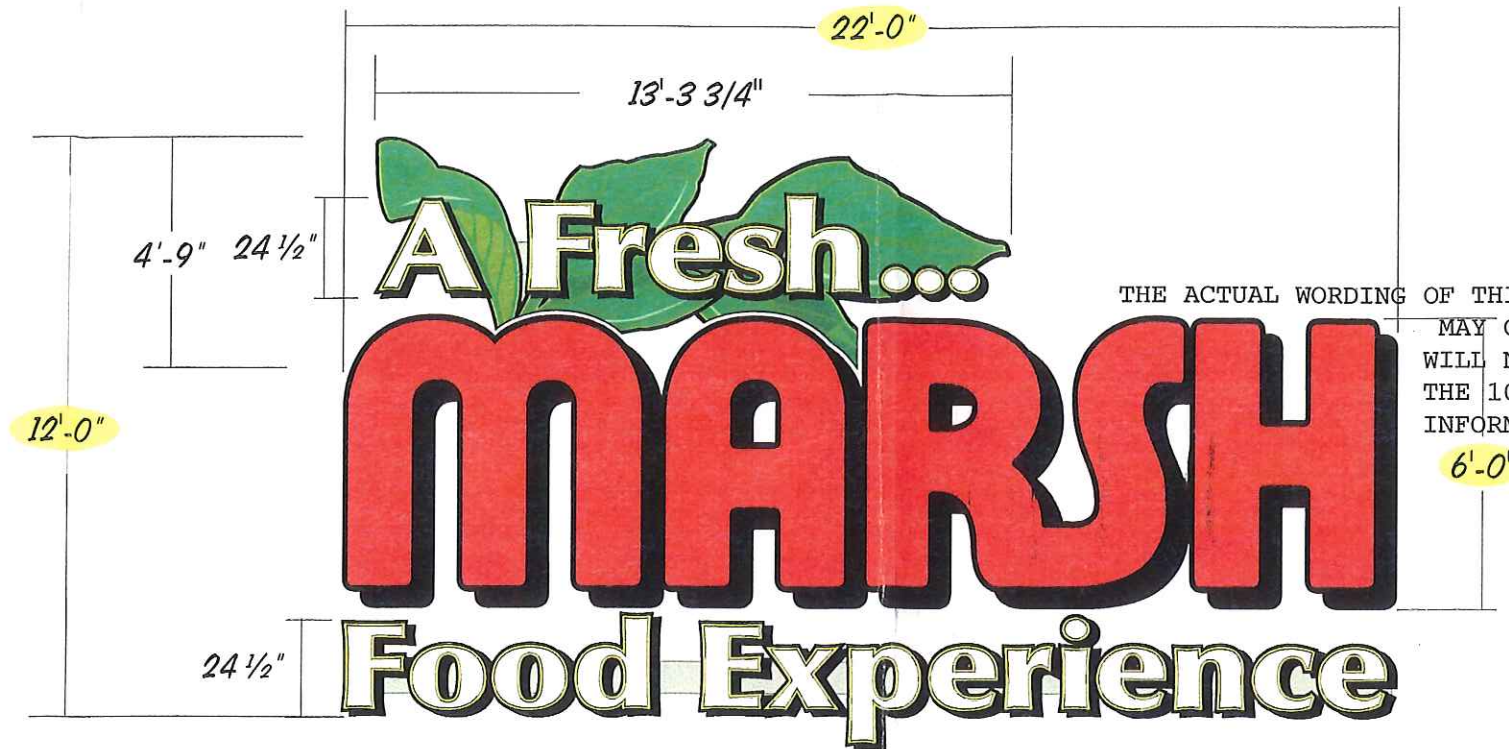
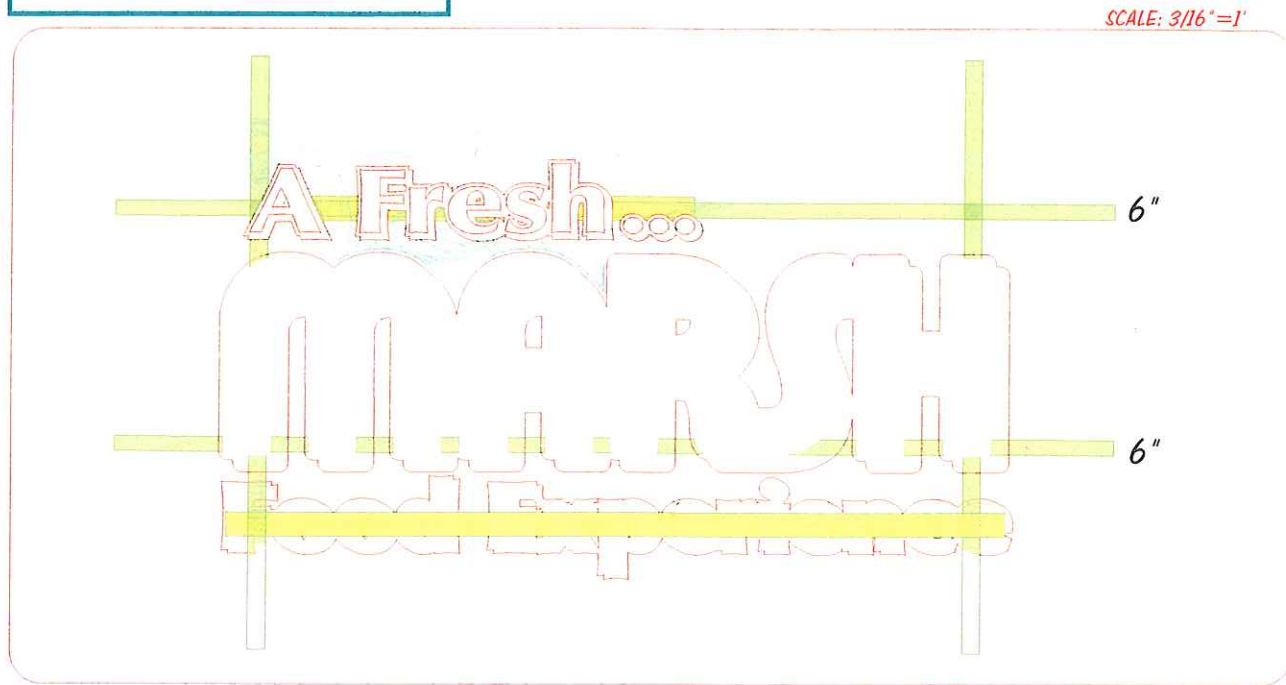

THE ACTUAL WORDING OF THIS SIGN MAY CHANGE BUT WILL NOT EXCEED THE 10 ITEMS of INFORMATION

THE PLAN COMMISSION APPROVED THESE TWO SIGNS BEING LOCATED ALONG THE SAME SIDE OF THE BUILDING (facing west)

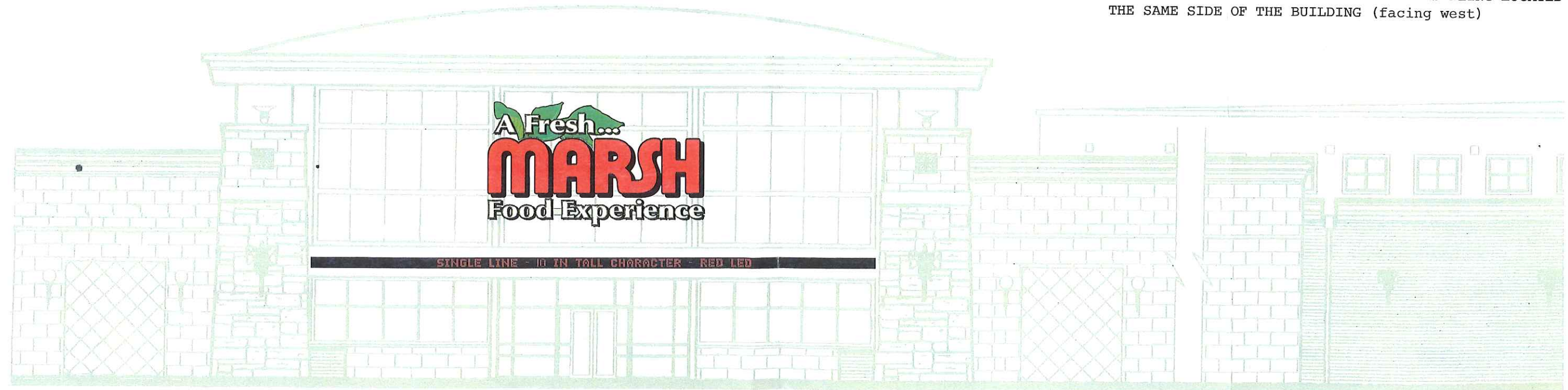

MESSAGE CENTER: CABINET SIZE-13" TALL X 57'-2" LONG X 8" DEEP

WEST ELEVATION SCALE: 3/32"=1'

**SIGN CRAFT INDUSTRIES**  
8920 CORPORATION DR.  
INDIANAPOLIS, IN 46256  
OFFICE 317.842.8664  
FAX 317.842.3015



PREPARED FOR:	SKETCH NAME	SCALE:	DATE:	S. C. REP:	CUSTOMER APPROVAL:
MARSH CONCEPT STORE #37 NOBLESVILLE, IN	37 ELEVATION 1C	1/4" = 1' 0"	AUGUST 19, 2003	STEVE McVICKER	

SALESPERSON: \_\_\_\_\_ DATE: \_\_\_\_\_

NOTE: THIS DRAWING WAS CREATED BY SIGN CRAFT INDUSTRIES INC. FOR YOUR APPROVAL IT IS NOT TO BE REPRODUCED, COPIED, OR EXHIBITED IN ANY FASHION

Smcvicker@buysigncraft.com

APPROVAL DATE: \_\_\_\_\_  
CHANGES INDICATED  
SUBMIT REVISED DRAWING