

# CITY OF NOBLESVILLE ALTERNATIVE TRANSPORTATION PLAN UPDATE 2015

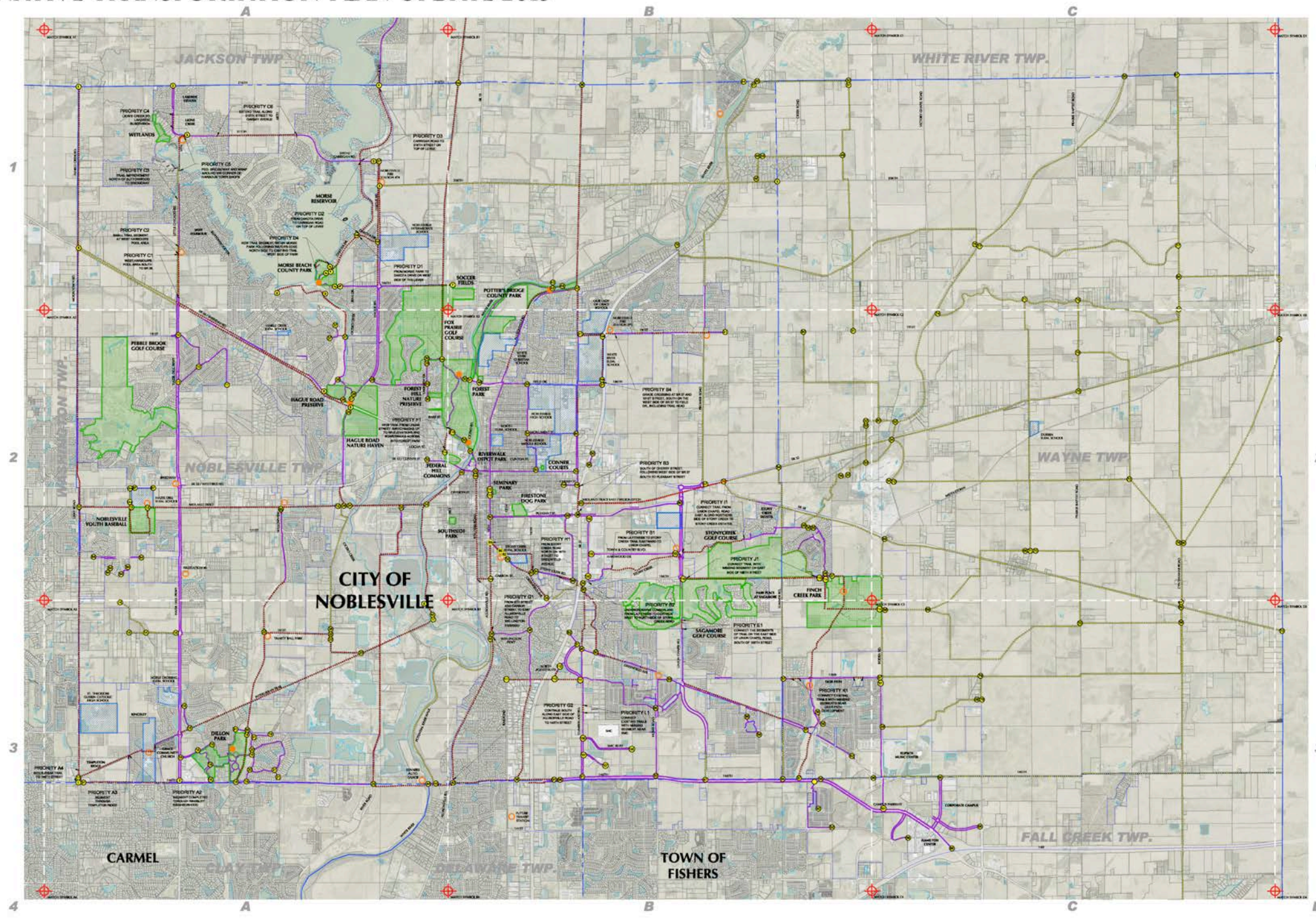

**LEGEND**

- EXISTING PARK, GOLF COURSE OR OPEN SPACE
- SCHOOL, MUNICIPAL OR CIVIC PROPERTY
- CORPORATE LIMITS
- GOLF COURSE
- EXISTING TRAIL HEAD
- PROPOSED TRAIL HEAD
- TOWNSHIP BOUNDARY
- MATCH SYMBOL
- EXISTING TRAIL
- POSSIBLE TRAIL
- PLANNED TRAIL
- PRIORITY A1 PRIORITY TRAIL SEGMENT

**MAP LEGEND**

A1	B1	C1
A2	B2	C2
A3	B3	C3

**LEHMAN & LEHMAN**  
Transforming Horizons

310 LINCOLNWAY EAST, SUITE C MISHAWAKA, IN 46544 TEL: 574.257.0255 FAX: 574.257.1966  
LANDSCAPE ARCHITECTURE AND PLANNING WWW.LEHMANANDLEHMAN.COM  
Copyright © 2015 Lehman & Lehman Inc. All Rights Reserved.

**NAT Plan Update**  
Noblesville, IN

SCALE: 0 1000 2000 4000

PREPARED FOR: Noblesville Park and Recreation Department

LOCATION: Noblesville, Indiana

DATE: April 1, 2015

**BASE MAP DISCLAIMER:**  
Base map information (GIS, aerial photography, etc.) were prepared by the City of Noblesville and provided to Lehman & Lehman for use on this project. Lehman & Lehman, Inc. assumes no liability for the accuracy of this information.



# CITY OF NOBLESVILLE ALTERNATIVE TRANSPORTATION PLAN 2015-SECTION A1

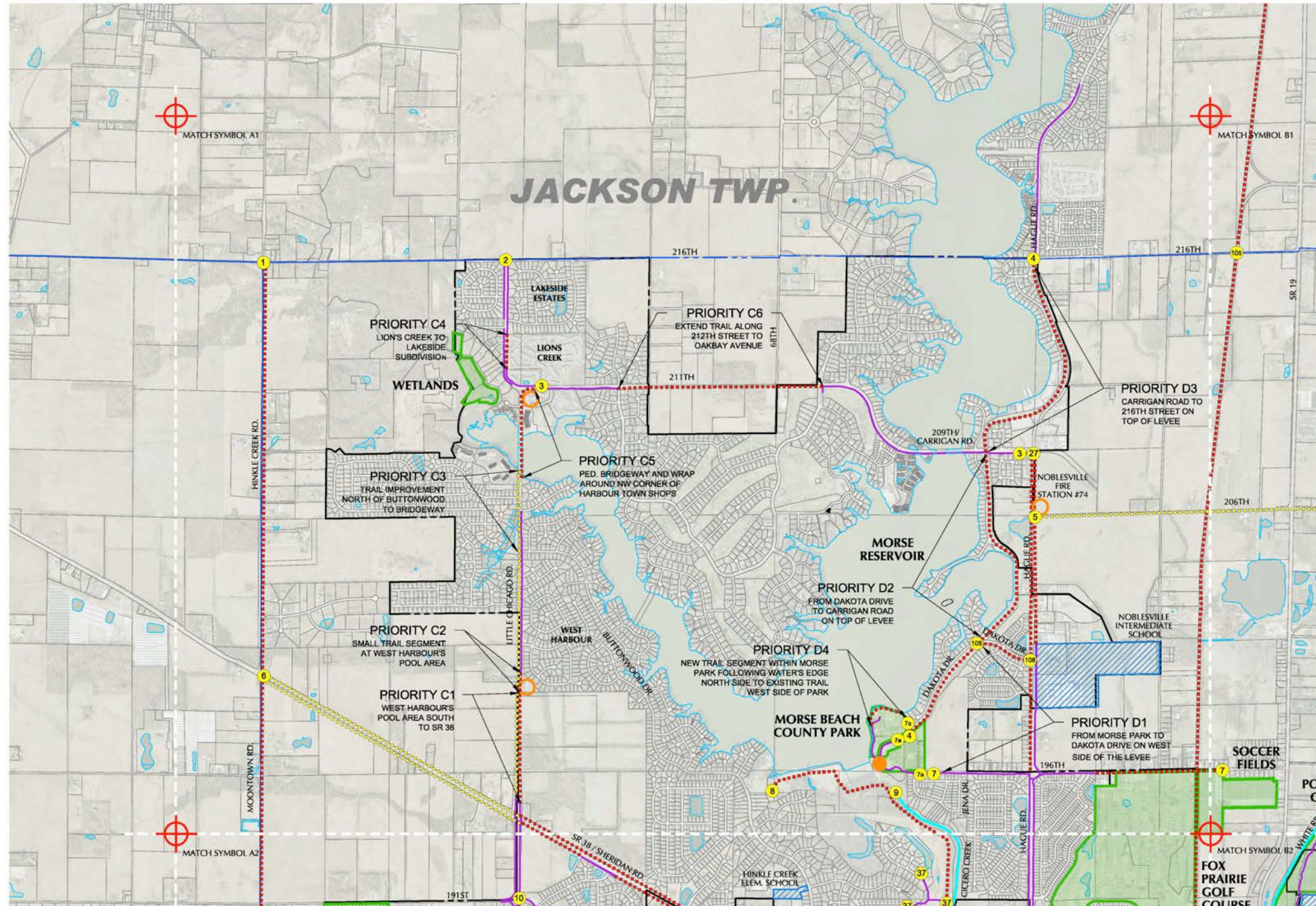

**LEGEND**

- EXISTING PARK, GOLF COURSE OR OPEN SPACE
- CORPORATE LIMITS
- EXISTING TRAIL HEAD
- TOWNSHIP BOUNDARY
- EXISTING TRAIL
- PLANNED TRAIL
- SCHOOL, MUNICIPAL OR CIVIC PROPERTY
- GOLF COURSE
- PROPOSED TRAIL HEAD
- MATCH SYMBOL
- POSSIBLE TRAIL
- PRIORITY A1 PRIORITY TRAIL SEGMENT

**MAP LEGEND**

A1	B1	C1
A2	B2	C2
A3	B3	C3

**NOTE:**  
 ANY TRAIL SEGMENTS (1) NOT FULLY REPRESENTED ON MAP SHOWN CAN BE FOUND ON ADJACENT MAPS

**LEHMAN & LEHMAN**  
 Transforming Horizons

310 LINCOLNWAY EAST, SUITE C, MISSAWAKA, IN 46544 TEL: 574.257.0235 FAX: 574.257.1966  
 LANDSCAPE ARCHITECTURE AND PLANNING WWW.LEHMANANDLEHMAN.COM  
 Copyright © 2015 Lehman & Lehman Inc. All Rights Reserved.

**NAT Plan Update**  
 Noblesville, IN

NORTH

SCALE: 0 400 800 1600

PREPARED FOR: Noblesville Park and Recreation Department  
 LOCATION: Noblesville, Indiana  
 DATE: April 1, 2015

**BASE MAP DISCLAIMER:**  
 Base map information (GIS, aerial photography, etc.) were prepared by the City of Noblesville and provided to Lehman & Lehman for use on this project. Lehman & Lehman, Inc. assumes no liability for the accuracy of this information.



# CITY OF NOBLESVILLE ALTERNATIVE TRANSPORTATION PLAN 2015-SECTION A2

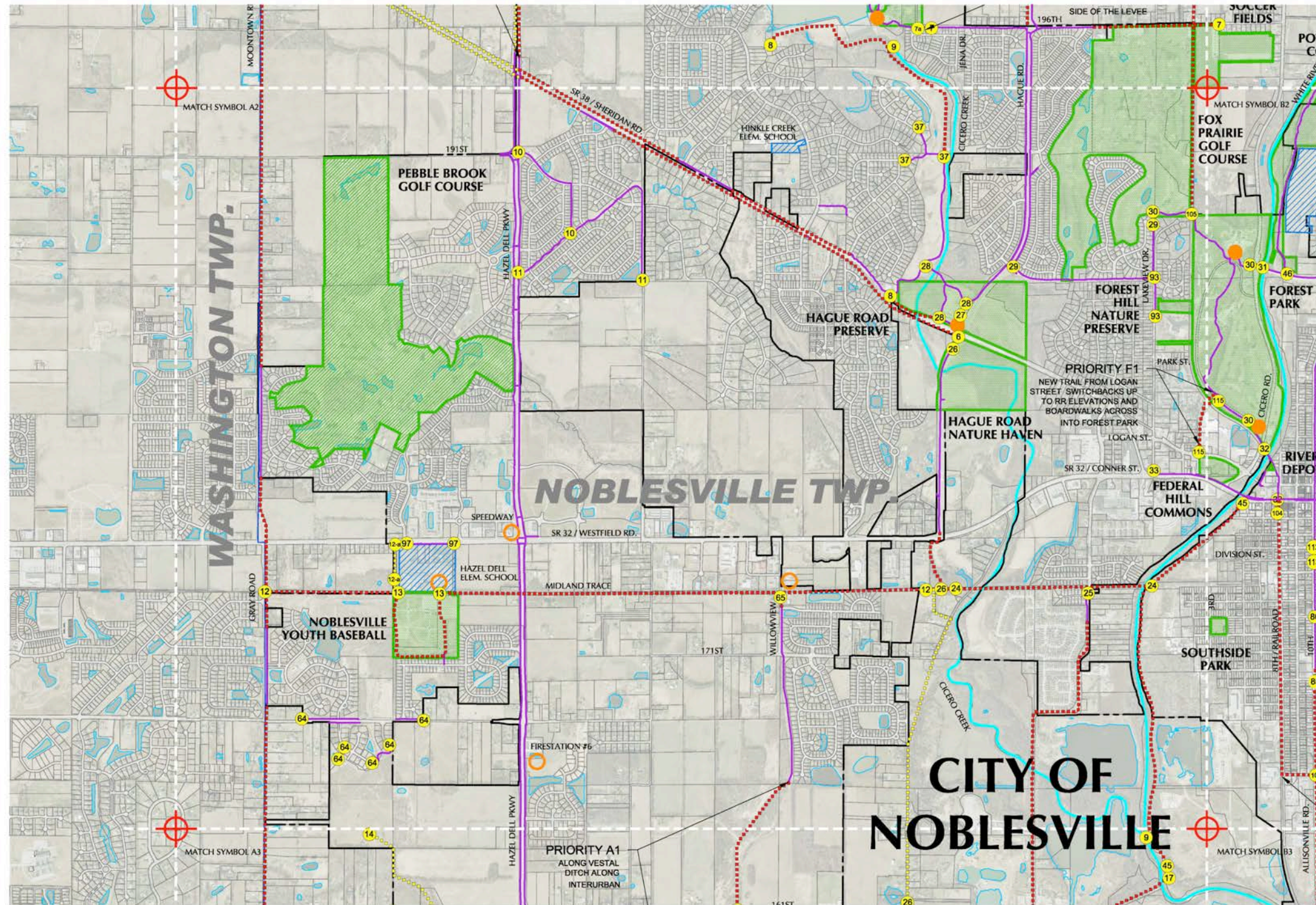

**LEGEND**

EXISTING PARK, GOLF COURSE OR OPEN SPACE	SCHOOL, MUNICIPAL OR CIVIC PROPERTY
CORPORATE LIMITS	GOLF COURSE
EXISTING TRAIL HEAD	PROPOSED TRAIL HEAD
TOWNSHIP BOUNDARY	MATCH SYMBOL
EXISTING TRAIL	POSSIBLE TRAIL
PLANNED TRAIL	PRIORITY A1 PRIORITY TRAIL SEGMENT

A1	B1	C1
A2	B2	C2
A3	B3	C3

MAP LEGEND

**NOTE:**  
ANY TRAIL SEGMENTS (B) NOT FULLY REPRESENTED ON MAP SHOWN CAN BE FOUND ON ADJACENT MAPS

**LEHMAN & LEHMAN**  
Transforming Horizons

510 LINCOLNWAY EAST, SUITE C, MISHAWAKA, IN 46544 TEL: 574.257.0235 FAX: 574.257.1966  
LANDSCAPE ARCHITECTURE AND PLANNING WWW.LEHMANANDLEHMAN.COM

**NAT Plan Update**  
Noblesville, IN

**SCALE:** 0 400 800 1600

PREPARED FOR: Noblesville Park and Recreation Department  
LOCATION: Noblesville, Indiana  
DATE: April 1, 2015

**BASE MAP DISCLAIMER:**  
Base map information (GIS, aerial photography, etc.) were prepared by the City of Noblesville and provided to Lehman & Lehman for use on this project. Lehman & Lehman, Inc. assumes no liability for the accuracy of this information.



# CITY OF NOBLESVILLE ALTERNATIVE TRANSPORTATION PLAN 2015-SECTION A3

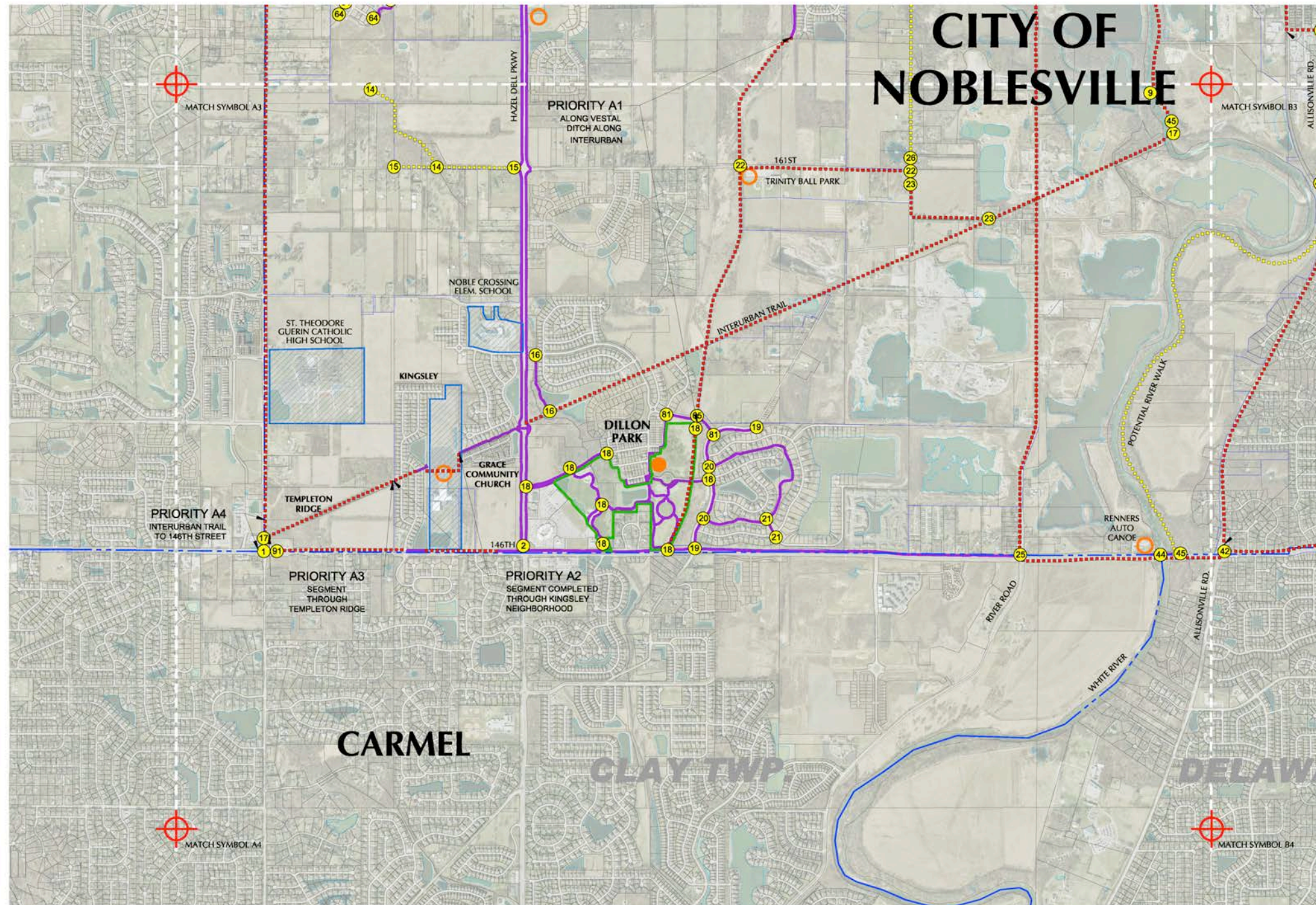

**LEGEND**

EXISTING PARK, GOLF COURSE OR OPEN SPACE	SCHOOL, MUNICIPAL OR CIVIC PROPERTY
CORPORATE LIMITS	GOLF COURSE
EXISTING TRAIL HEAD	PROPOSED TRAIL HEAD
TOWNSHIP BOUNDARY	MATCH SYMBOL
EXISTING TRAIL	POSSIBLE TRAIL
PLANNED TRAIL	PRIORITY A1 PRIORITY TRAIL SEGMENT

A1	B1	C1
A2	B2	C2
A3	B3	C3

MAP LEGEND

**NOTE:**  
 ANY TRAIL SEGMENTS (1) NOT FULLY REPRESENTED ON MAP SHOWN CAN BE FOUND ON ADJACENT MAPS

**LEHMAN & LEHMAN**  
 Transforming Horizons

310 LINCOLNWAY EAST, SUITE C MISHAWAKA, IN 46544 TEL: 574.257.0255 FAX: 574.257.1966  
 LANDSCAPE ARCHITECTURE AND PLANNING WWW.LEHMANANDLEHMAN.COM  
 Copyright © 2015 Lehman & Lehman, Inc. All Rights Reserved.

**NAT Plan Update  
 Noblesville, IN**

**SCALE:** 0 50 100

PREPARED FOR: Noblesville Park and Recreation Department  
 LOCATION: Noblesville, Indiana  
 DATE: April 1, 2015

**BASE MAP DISCLAIMER:**  
 Base map information (GIS, aerial photography, etc.) were prepared by the City of Noblesville and provided to Lehman & Lehman for use on this project. Lehman & Lehman, Inc. assumes no liability for the accuracy of this information.



# CITY OF NOBLESVILLE ALTERNATIVE TRANSPORTATION PLAN 2015-SECTION B1

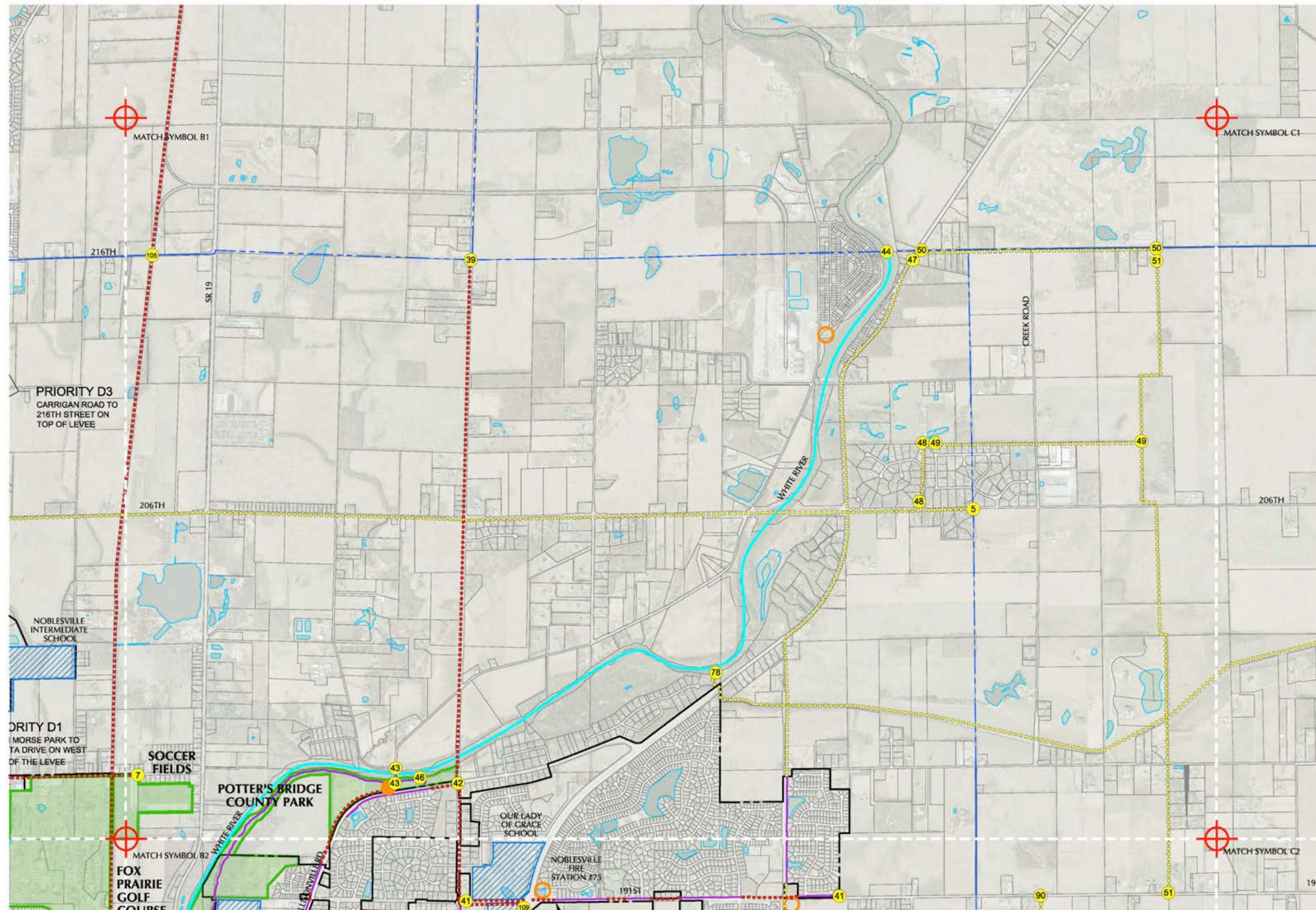

**LEGEND**

EXISTING PARK, GOLF COURSE OR OPEN SPACE	SCHOOL, MUNICIPAL OR CIVIC PROPERTY
CORPORATE LIMITS	GOLF COURSE
EXISTING TRAIL HEAD	PROPOSED TRAIL HEAD
TOWNSHIP BOUNDARY	MATCH SYMBOL
EXISTING TRAIL	POSSIBLE TRAIL
PLANNED TRAIL	PRIORITY A1 PRIORITY TRAIL SEGMENT

**MAP LEGEND**

A1	B1	C1
A2	B2	C2
A3	B3	C3

**NOTE:**  
ANY TRAIL SEGMENTS (1) NOT FULLY REPRESENTED ON MAP SHOWN CAN BE FOUND ON ADJACENT MAPS

**LEHMAN & LEHMAN**  
Transforming Horizons

310 LINCOLNWAY EAST, SUITE C, MISHAWAKA, IN 46544 TEL: 574.257.0235 FAX: 574.257.1966  
LANDSCAPE ARCHITECTURE AND PLANNING WWW.LEHMANANDLEHMAN.COM  
Copyright © 2015 Lehman & Lehman Inc. All Rights Reserved.

**NAT Plan Update**  
Noblesville, IN

**SCALE:** 0 400 800 1600

PREPARED FOR: Noblesville Park and Recreation Department  
LOCATION: Noblesville, Indiana  
DATE: April 1, 2015

**BASE MAP DISCLAIMER:**  
Base map information (GIS, aerial photography, etc.) were prepared by the City of Noblesville and provided to Lehman & Lehman, Inc. for use on this project. Lehman & Lehman, Inc. assumes no liability for the accuracy of this information.



# CITY OF NOBLESVILLE ALTERNATIVE TRANSPORTATION PLAN 2015-SECTION B2

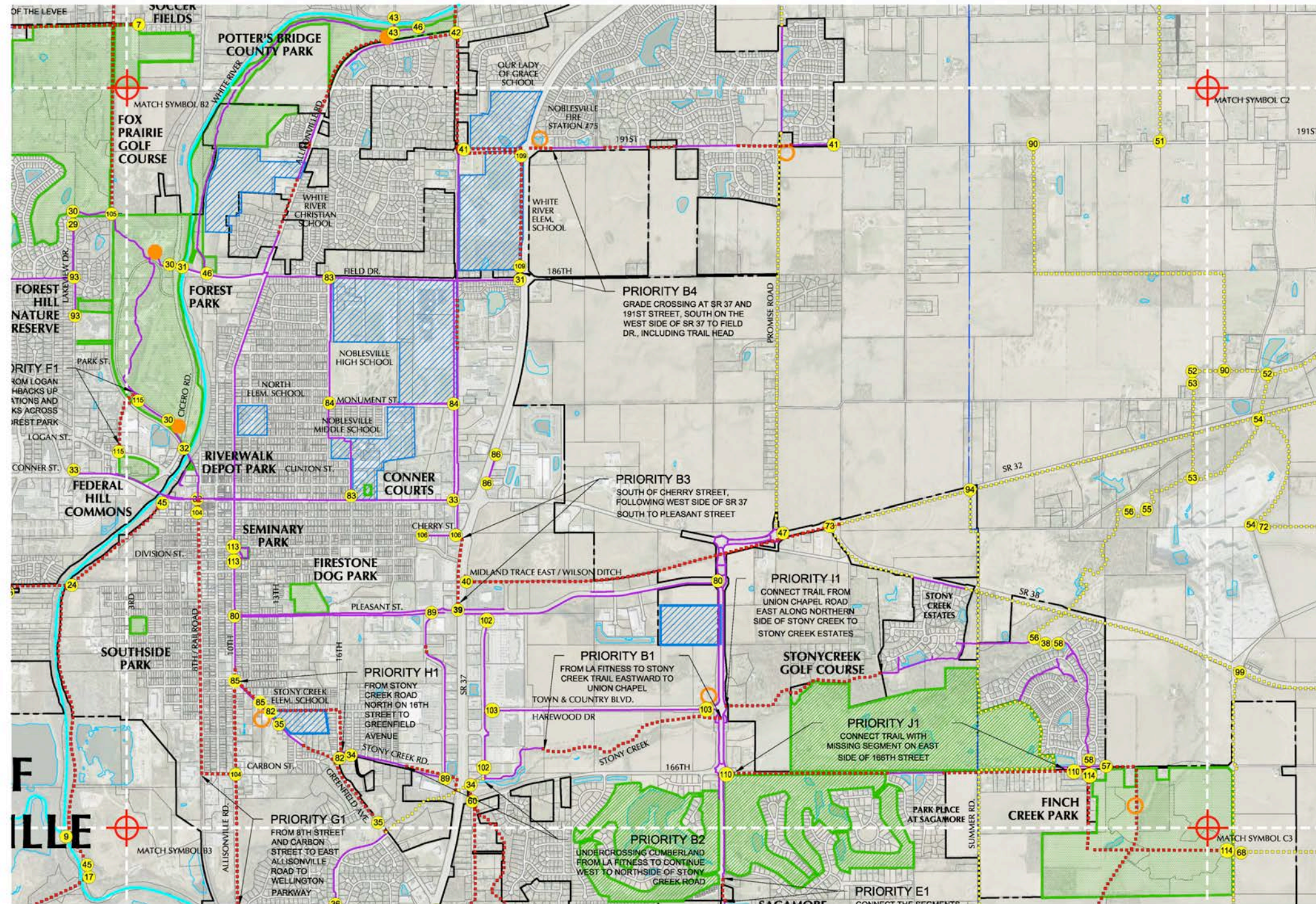

**LEGEND**

EXISTING PARK, GOLF COURSE OR OPEN SPACE	SCHOOL, MUNICIPAL OR CIVIC PROPERTY
CORPORATE LIMITS	GOLF COURSE
EXISTING TRAIL HEAD	PROPOSED TRAIL HEAD
TOWNSHIP BOUNDARY	MATCH SYMBOL
EXISTING TRAIL	POSSIBLE TRAIL
PLANNED TRAIL	PRIORITY A1 PRIORITY TRAIL SEGMENT

**MAP LEGEND**

A1	B1	C1
A2	B2	C2
A3	B3	C3

**NOTE:**  
 ANY TRAIL SEGMENTS (B) NOT FULLY REPRESENTED ON MAP SHOWN CAN BE FOUND ON ADJACENT MAPS



# CITY OF NOBLESVILLE ALTERNATIVE TRANSPORTATION PLAN 2015-SECTION B3

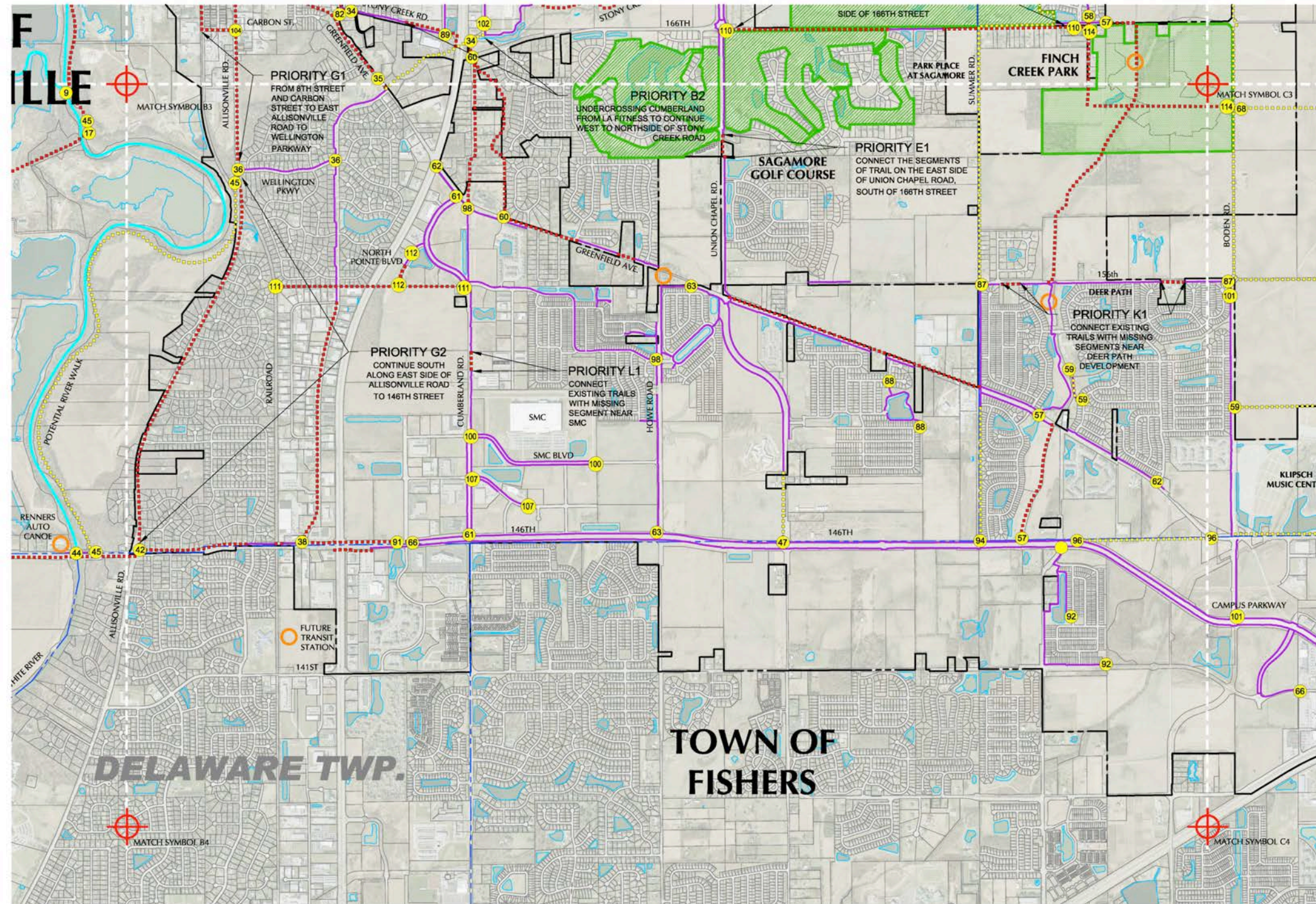

**LEGEND**

- EXISTING PARK, GOLF COURSE OR OPEN SPACE
- CORPORATE LIMITS
- EXISTING TRAIL HEAD
- TOWNSHIP BOUNDARY
- EXISTING TRAIL
- PLANNED TRAIL
- SCHOOL, MUNICIPAL OR CIVIC PROPERTY
- GOLF COURSE
- PROPOSED TRAIL HEAD
- MATCH SYMBOL
- POSSIBLE TRAIL
- PRIORITY A1 PRIORITY TRAIL SEGMENT

A1	B1	C1
A2	B2	C2
A3	B3	C3

MAP LEGEND

**NOTE:**  
ANY TRAIL SEGMENTS (B) NOT FULLY REPRESENTED ON MAP SHOWN CAN BE FOUND ON ADJACENT MAPS

**LEHMAN & LEHMAN**  
Transforming Horizons

510 LINCOLNWAY EAST, SUITE C, MISHAWAKA, IN 46544 TEL: 574.257.0235 FAX: 574.257.1966  
LANDSCAPE ARCHITECTURE AND PLANNING WWW.LEHMANANDLEHMAN.COM

**NAT Plan Update**  
Noblesville, IN

SCALE: 0 400 800 1600

PREPARED FOR: Noblesville Park and Recreation Department

LOCATION: Noblesville, Indiana

DATE: April 1, 2015

**BASE MAP DISCLAIMER:**  
Base map information (GIS, aerial photography, etc.) were prepared by the City of Noblesville and provided to Lehman & Lehman for use on this project. Lehman & Lehman, Inc. assumes no liability for the accuracy of this information.



# CITY OF NOBLESVILLE ALTERNATIVE TRANSPORTATION PLAN 2015-SECTION C1

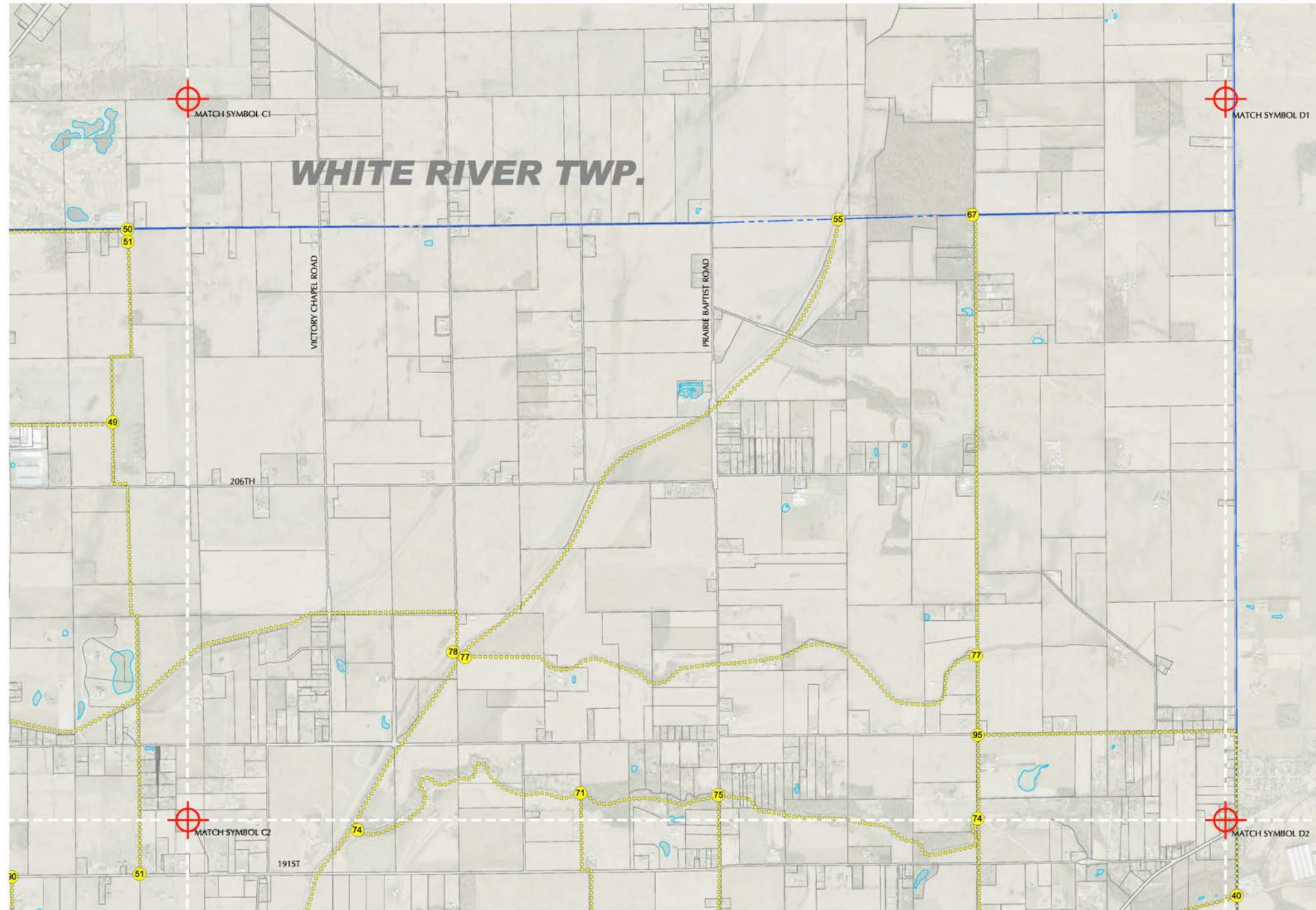

**LEGEND**

EXISTING PARK, GOLF COURSE OR OPEN SPACE	SCHOOL, MUNICIPAL OR CIVIC PROPERTY
CORPORATE LIMITS	GOLF COURSE
EXISTING TRAIL HEAD	PROPOSED TRAIL HEAD
TOWNSHIP BOUNDARY	MATCH SYMBOL
EXISTING TRAIL	POSSIBLE TRAIL
PLANNED TRAIL	PRIORITY A1 PRIORITY TRAIL SEGMENT

A1	B1	C1
A2	B2	C2
A3	B3	C3

MAP LEGEND

**NOTE:**  
 ANY TRAIL SEGMENTS (B) NOT FULLY REPRESENTED ON MAP SHOWN CAN BE FOUND ON ADJACENT MAPS

**LEHMAN & LEHMAN**  
 Transforming Horizons

310 LINCOLNWAY EAST, SUITE C, MISHAWAKA, IN 46544 TEL: 574.257.0235 FAX: 574.257.1966  
 LANDSCAPE ARCHITECTURE AND PLANNING WWW.LEHMANANDLEHMAN.COM  
 Copyright © 2015 Lehman & Lehman Inc. All Rights Reserved.

**NAT Plan Update**  
 Noblesville, IN

NORTH

SCALE: 0 400 800 1600

PREPARED FOR: Noblesville Park and Recreation Department  
 LOCATION: Noblesville, Indiana  
 DATE: April 1, 2015

**BASE MAP DISCLAIMER:**  
 Base map information (GIS, aerial photography, etc.) were prepared by the City of Noblesville and provided to Lehman & Lehman, Inc. for use on this project. Lehman & Lehman, Inc. assumes no liability for the accuracy of this information.



# CITY OF NOBLESVILLE ALTERNATIVE TRANSPORTATION PLAN 2015-SECTION C2



**LEGEND**

EXISTING PARK, GOLF COURSE OR OPEN SPACE	SCHOOL, MUNICIPAL OR CIVIC PROPERTY
CORPORATE LIMITS	GOLF COURSE
EXISTING TRAIL HEAD	PROPOSED TRAIL HEAD
TOWNSHIP BOUNDARY	MATCH SYMBOL
EXISTING TRAIL	POSSIBLE TRAIL
PLANNED TRAIL	PRIORITY 1 PRIORITY TRAIL SEGMENT

**MAP LEGEND**

A1	B1	C1
A2	B2	C2
A3	B3	C3

**NOTE:**  
ANY TRAIL SEGMENTS (1) NOT FULLY REPRESENTED ON MAP SHOWN CAN BE FOUND ON ADJACENT MAPS

**LEHMAN & LEHMAN**  
Transforming Horizons

310 LINCOLNWAY EAST, SUITE C, MISSAWAKA, IN 46544 TEL: 574.257.0235 FAX: 574.257.1966  
LANDSCAPE ARCHITECTURE AND PLANNING WWW.LEHMANANDLEHMAN.COM  
Copyright © 2015 Lehman & Lehman Inc. All Rights Reserved.

**NAT Plan Update**  
Noblesville, IN

**SCALE:** 0 400 800 1600

**PREPARED FOR:** Noblesville Park and Recreation Department  
**LOCATION:** Noblesville, Indiana  
**DATE:** April 1, 2015

**BASE MAP DISCLAIMER:**  
Base map information (GIS, aerial photography, etc.) were prepared by the City of Noblesville and provided to Lehman & Lehman for use on this project. Lehman & Lehman, Inc. assumes no liability for the accuracy of this information.



# CITY OF NOBLESVILLE ALTERNATIVE TRANSPORTATION PLAN 2015-SECTION C3

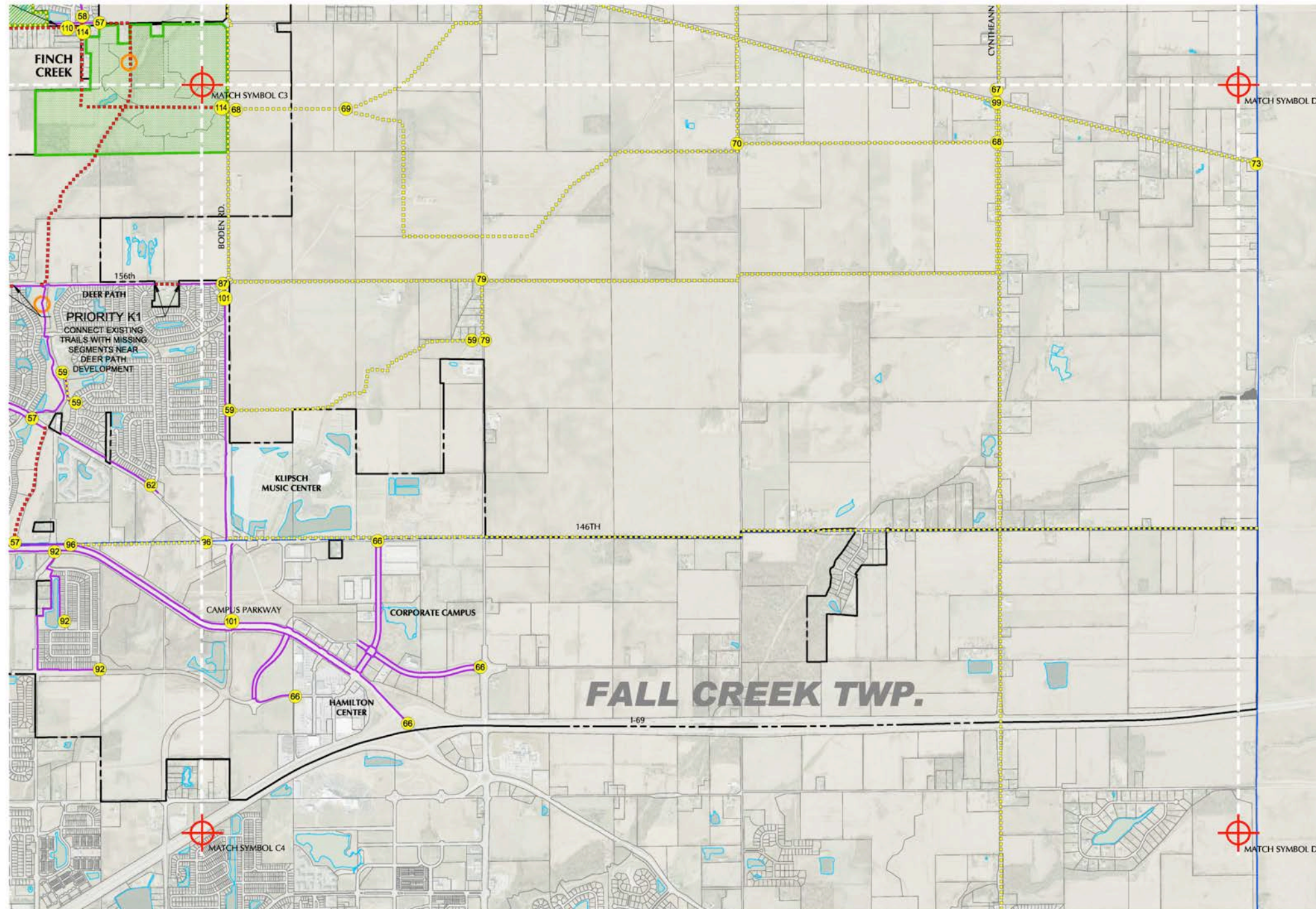

**LEGEND**

EXISTING PARK, GOLF COURSE OR OPEN SPACE	SCHOOL, MUNICIPAL OR CIVIC PROPERTY
CORPORATE LIMITS	GOLF COURSE
EXISTING TRAIL HEAD	PROPOSED TRAIL HEAD
TOWNSHIP BOUNDARY	MATCH SYMBOL
EXISTING TRAIL	POSSIBLE TRAIL
PLANNED TRAIL	PRIORITY A1 PRIORITY TRAIL SEGMENT

**NOTE:**  
 ANY TRAIL SEGMENTS (A1) NOT FULLY REPRESENTED ON MAP SHOWN CAN BE FOUND ON ADJACENT MAPS

A1	B1	C1
A2	B2	C2
A3	B3	C3

**MAP LEGEND**

**LEHMAN & LEHMAN**  
 Transforming Horizons

310 LINCOLNWAY EAST, SUITE C, MISHAWAKA, IN 46544 TEL: 574.257.0235 FAX: 574.257.1966  
 LANDSCAPE ARCHITECTURE AND PLANNING WWW.LEHMANANDLEHMAN.COM  
 Copyright © 2015 Lehman & Lehman Inc. All Rights Reserved.

**NAT Plan Update**  
 Noblesville, IN

SCALE:

PREPARED FOR: Noblesville Park and Recreation Department  
 LOCATION: Noblesville, Indiana  
 DATE: April 1, 2015

**BASE MAP DISCLAIMER:**  
 Base map information (GIS, aerial photography, etc.) were prepared by the City of Noblesville and provided to Lehman & Lehman for use on this project. Lehman & Lehman, Inc. assumes no liability for the accuracy of this information.